

Guide for International Students 2016-17

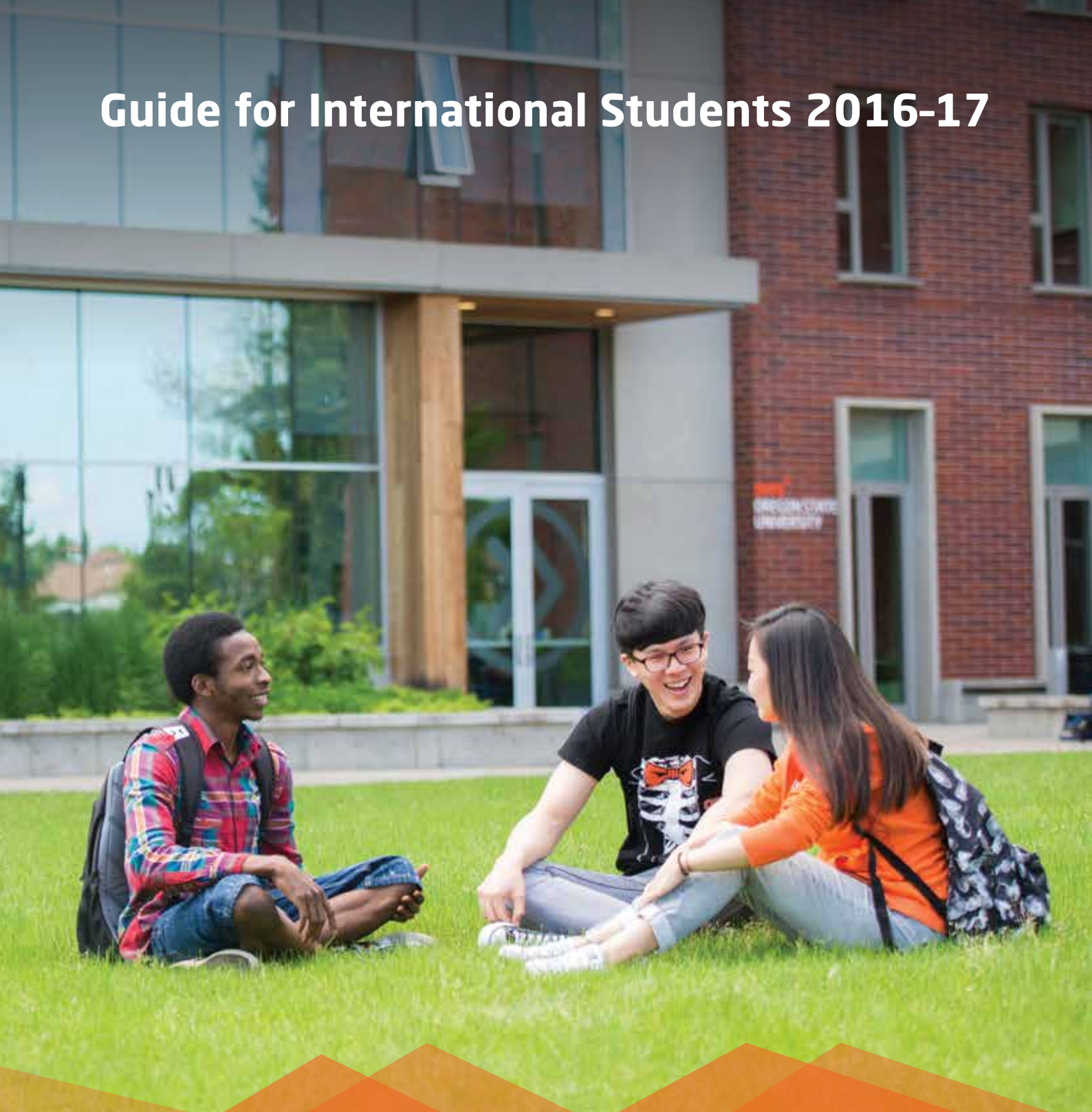

TOP 70

Public Schools in the US

#3

Best US College Town



INTO® OREGON STATE UNIVERSITY

Oregon State
UNIVERSITY

Oregon State University

- 7 Corvallis, Oregon
- 9 OSU for International Students
- 9 OSU-Cascades
- 10 OSU Academic Programs
- 13 Academic Colleges
- 15 INTO Oregon State University

Undergraduate

- 18 Undergraduate Direct Entry
- 20 Undergraduate Pathway Programs

Graduate

- 32 Graduate Direct Entry
- 34 Graduate Pathway Programs

English Language Program

- 46 Academic English
- 47 General English
- 48 Study Abroad with English
- 49 Visiting International Student Program

Student Life

- 53 Academic Success
- 55 University Student Services
- 57 The INTO OSU Difference
- 59 Sports and Recreation
- 61 Being an OSU Student
- 63 Living on Campus
- 65 Housing Options
- 67 Career Preparation
- 68 Alumni and Parents
- 69 Scholarships

Your Application

- 72 INTO OSU Application Process
- 73 INTO OSU Application
- 77 Affidavit of Support
- 78 Country Scales
- 80 English Waiver Guidelines
- 81 Dates, Tuition and Fees



\$285M

in research funding
received in 2013-14

Welcome to Oregon State University!

For nearly 150 years, OSU has been at the forefront of innovation and diversity. Consistently recognized as a leading research university, OSU is one of only 40 public universities in the US with the Carnegie Foundation's Tier 1 Very High Research Activity and Community Engagement designations. Our record of achievement and quality of professionalism are a result of the combined efforts of current students, alumni and researchers alike.

The campus community has been built on delivering a cleaner, safer and more sustainable quality of living and contributes to the enhancement of citizens all around the world. We focus on the preservation of future generations by raising global awareness and inspiring action. The university continues to reach new levels of improvement in social progress, student success and collaborative learning, giving graduates countless opportunities to connect with peers and colleagues.

OSU's commitment to experiential learning and research helps graduates develop relevant industry relationships and brings notoriety to student discoveries and accomplishments. Student experience and engagement are our top priority as we strive for the happiness and success of all our students. Our diverse academic clubs and organizations offer students the opportunity to pursue and apply their interests, build skills in and out of the classroom and prepare for their future career.

Discover OSU, invest in your life and take part in our vision for a better tomorrow!



“At Oregon State University, we are committed to further developing as a vibrant international community. We proudly invite the world’s students and faculty to study, teach and conduct research here. I encourage you to join our community of scholars at our diverse and welcoming campus.”

Edward Ray, PhD
President
Oregon State University

Tier 1 Very High Research
Activity and Community
Engagement designation
(Carnegie Foundation for the
Advancement of Teaching)



Top 250 Global Universities
(U.S. News & World Report 2014)



#38

Green Schools in the US
(The Princeton Review 2015)



#138

in the National
University Rankings
(U.S. News & World Report 2015)

Oregon State University



#41

Top Research
University in the US
(Best College Reviews 2015)

#44

Best Buy Schools
*(The Fiske Guide to
Colleges 2016)*

▼ Corvallis, Oregon



▼ OSU Main Campus

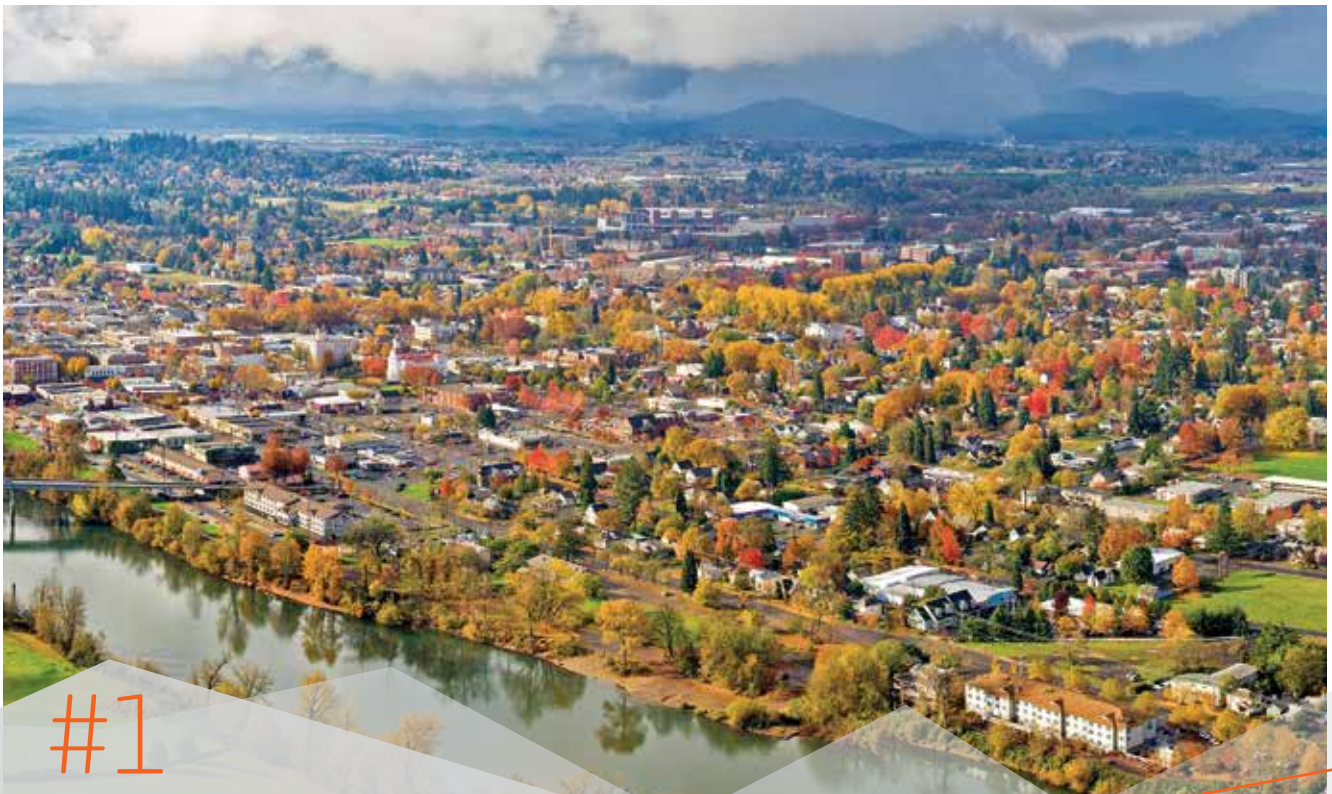

#1

Most Secure
Small City in the US
(Farmers Insurance 2013)



Corvallis, Oregon

Located in the Willamette Valley of Oregon's stunning landscapes and beautiful weather, Corvallis is home to a very unique culture and way of living for students and locals alike. The diverse nature appeals to our community and contributes to making Corvallis one of the best environments in the US for exploring, learning and networking with people from all around the world.

The State

Found in the heart of the Pacific Northwest, Oregon is located between the states of California and Washington, allowing visitors and residents to see nearby cities and local attractions, such as Portland or Crater Lake. So whether you love walking on the beach or skiing in the mountains, the Cascade Mountain Range and Pacific coast offer scenic and recreational activities like nowhere else in the United States.

The Town

Corvallis allows people, of all ages and backgrounds, the chance to experience something new year-round; tax-free shopping and visiting markets, restaurants, local wineries and brew pubs. Known as one of the safest, smartest, greenest small cities in the US, Corvallis has a population of about 55,000 and is consistently recognized as one of the best places to live in America.

The Campus

Home to Oregon State University, the historic 400 acre campus and the surrounding community provide students with the opportunity to experience one of the best college towns in the US. Known for its influential research, OSU is academically ranked as one of the top 70 public schools in the US, as well as leading the nation in sustainable transportation, energy, food sourcing and natural resources.



#2

Most Educated City in America
(Smart Asset 2014)

#4

Most Innovative City in the US
(Nerd Wallet 2015)

OSU At-a-Glance

Founded: 1868

Enrollment: 28,886

International Students: 3,884

Countries Represented: 100

Bachelor's Degrees: 200+

Master's/PhD Degrees: 80+

Campus Size: 400 acres

Research: \$285M

Faculty: 1,079 full-time, 337 part-time



▼ OSU-Cascades campus



facebook.com/osubeavers



twitter.com/oregonstateuniv

OSU for International Students

Oregon State University is dedicated to the success and well-being of our students. We offer a variety of programs for international students providing them with the essential support they need to be successful in an American university.

A Premier Public Research University

Founded in 1868, Oregon State University is one of only two universities in the United States to have Land Grant, Sea Grant, Space Grant and Sun Grant designations. This means OSU is involved with world-changing research in all four areas, something very unique among American universities.

Oregon State is among the nation's leading research institutions in a range of fields, including forestry, climate change, wave energy, sustainable food systems, computer science, environmental science, chemical and mechanical engineering and robotics.

Paths for International Students

Direct Entry

Students who meet the specified language and academic criteria may apply directly to Oregon State University. Students who do not meet these requirements are encouraged to apply to our Pathway and English language programs.

Undergraduate Pathway Programs

Our undergraduate Pathway programs combine intensive language study, academic skills development and academic course work in a carefully constructed program designed to move students successfully through the first year of an undergraduate degree program.

Graduate Pathway Programs

The Graduate Pathway program is a pre-master's program that provides international students a direct path to various graduate degrees at the university. The program gives students the academic foundation, essential language skills and GMAT/GRE test preparation to successfully move on to a master's degree program.

English Language Program

Students can also choose from a range of English language programs to help meet their personal and professional goals. There are many opportunities through classroom instruction and outside of the classroom to engage with other domestic and international students.

OSU-Cascades

Small Campus Feel – Big University Resources

Oregon State University also has a campus in Bend, Oregon, in a region known for rugged beauty, sunny skies and unlimited outdoor recreational opportunities. At the OSU-Cascades campus, students find the advantages of a premier research university in a personalized, small-campus environment. It is a great option for international students looking for a

smaller learning environment. Here, you can experience American culture in a vibrant small city, explore the great outdoors and pursue a degree with the excellent resources of Oregon State University. With just over 1,000 students, international students quickly find themselves immersed in the campus community as well as in the region's local culture.

OSU-Cascades Offers:

- 18 undergraduate and 3 graduate degree programs, plus 30 minors and options
- Just over 1,000 students, creating the feel of a small college campus with the many resources of OSU
- Small classes with an average student-faculty ratio of 16:1
- A beautiful location in Bend, about 2.5 hours east of Corvallis and 3 hours southeast of Portland in the Cascade Mountain Range



[youtube.com/user/oregonstateuniv](https://www.youtube.com/user/oregonstateuniv)



[instagram.com/oregonstateuniv](https://www.instagram.com/oregonstateuniv)

OSU Academic Programs

	Bachelor's	Master's	Doctorate
College of Agricultural Sciences			
Agriculture		●	
Agricultural Business Management	⊙		
Agricultural Education		●	
Agricultural Sciences	⊙		
Animal Sciences [BS options: Animal Management, Pre-Veterinary Medicine]	⊙	●	●
Applied Economics		●	●
Applied Systematics in Botany		●	
Bioresource Research [BS options: Animal Reproduction and Development, Applied Genetics, Bioproducts, Bioenergy, Biotechnology, Climate and Biosystems Modeling, Environmental Chemistry, Food Quality, Genomics/Bioinformatics, Pest Biology and Management, Plant Growth and Development, Sustainable Ecosystems, Toxicology, Water Resources]	⊙		
Botany [BS options: Botanical Research, Fungal Biology, Plant Ecology and Systematics, Plant Molecular Genetics and Biotechnology, Pre-Professional Teaching Botany]	⊙		
Botany and Plant Pathology		●	●
Crop and Soil Science [BS options: Agronomy, Plant Breeding and Genetics]	⊙		
Crop Science [BS options: Entomology, Plant Breeding and Genetics]		●	●
Entomology		●	●
Environmental Economics and Policy [BS options: Environmental Economics, Environmental Policy, General]	⊙		
Fisheries and Wildlife Administration		●	
Fisheries and Wildlife Sciences	⊙		
Fisheries Management (Graduate Certificate)		●	
Fisheries Science		●	●
Food Science and Technology [BS options: Food Science, Fermentation Science, Enology and Viticulture]	⊙	●	●
Horticulture [BS options: Ecological and Sustainable Horticultural Production, Ecology Landscape and Urban Forestry, General Horticulture, Horticultural Research, Plant Breeding and Genetics, Therapeutic Horticulture, Turf Management, Viticulture and Enology]	⊙	●	●
Rangeland Sciences	⊙		
Rangeland Ecology and Management		●	●
Soil Science		●	●
Sustainability	⊙		
Toxicology		●	●
Water Resources Engineering		●	●
Wildlife Science		●	●
College of Business			
Accountancy [BS options: Accounting Information Systems, International Business]	⊙		
Apparel Design	⊙		
Business Administration/MBA [BA/BS options: Entrepreneurship for Business Majors, General Business, Hospitality Management, International Business]	⊙	⊙	●
Accountancy MBA		●	
Business Information Systems [BA/BS option: International Business]	⊙		
Design and Human Environment		●	●
Finance [BA/BS option: International Business]	⊙		
Graphic Design	⊙		
Hospitality Management (OSU - Cascades campus only)	⊙		
Innovation Management	⊙		
Interior Design [BS options: Housing Studies, Interior Design]	⊙		
Management [BA/BS option: International Business]	⊙		
Marketing [BA/BS option: International Business]	⊙		
Merchandising Management	⊙		

	Bachelor's	Master's	Doctorate
College of Earth, Ocean and Atmospheric Sciences			
Earth Sciences [BS options: Earth Systems, Geography, Geology, Ocean Science]	⊙		
Environmental Sciences [BS options: Applied Ecology and Resource Management, Aquatic Biology, Environmental Chemistry for Environmental Sciences, Environmental Conservation and Sustainability, Environmental Policy, Land-Air Interaction, Pre-Education Environmental Science, Terrestrial Ecosystems, Water Science and Resources]	⊙	●	●
Geographic Information Science (Undergraduate and Graduate Certificate)	●	●	
Geography		●	●
Geology		●	●
Marine Resource Management (Graduate Certificate)		●	
Ocean, Earth and Atmospheric Sciences		●	●
Water Conflict Management and Transformation (Graduate Certificate)		●	
Water Resources Policy and Management		●	
Water Resources Science		●	●
College of Education			
Adult Education		●	
College Student Services Administration		●	
Counseling [Options: Clinical Mental Health, Counseling, School Counseling]		●	●
Education [BS options: Advanced Mathematics, Basic Mathematics, Biology, Chemistry, Early Childhood/Elementary, Family and Consumer Sciences, Health, Integrated Science, Language Arts, Physics, Social Studies]	⊙	●	●
Mathematics Education		●	●
Science Education		●	●
Teaching		●	
College of Engineering			
Bioengineering	⊙		
Biological and Ecological Engineering		●	●
Chemical Engineering [BA/BS options: Biochemical Processes, Environmental Processes, Microelectronics Processes and Materials Science, Nanotechnology Processes]	⊙	⊙	●
Civil Engineering [BA/BS option: Environmental Engineering] [Grad Option: Construction and Engineering Management]	⊙	⊙	●
Computer Science [BA/BS options: Applied Computer Science, Computer Systems]	⊙	⊙	●
Construction and Engineering Management	⊙		
Ecological Engineering	⊙		
Electrical and Computer Engineering	⊙	⊙	●
Energy Systems Engineering (OSU - Cascades campus only)	⊙		
Environmental Engineering	⊙	⊙	●
Industrial Engineering [BS option: Business Engineering]	⊙	⊙	●
Manufacturing Engineering	⊙		
Materials Science		⊙	●
Mechanical Engineering [Grad options: Advanced Manufacturing, Design, Materials Mechanics, Renewable Energy, Robotics, Thermal Fluid Sciences]	⊙	⊙	●
Medical Physics		●	●
Nuclear Engineering	⊙	●	●
Radiation Health Physics [BS option: Radiation Health Physics Pre-Med]	⊙	●	●
Robotics		●	●

☐ Indicates degree programs also available at OSU-Cascades

⊙ Indicates a Pathway program can lead to this degree

● Indicates an OSU degree program

Graduate Pathway programs leading to master's degrees are listed below in orange.

	Bachelor's	Master's	Doctorate		Bachelor's	Master's	Doctorate
College of Forestry				College of Pharmacy			
Forest Ecosystem and Society		●	●	Pharmaceutical Sciences [Biopharmaceutics, Medicinal Chemistry, Natural Products Chemistry, Pharmaceutics, Pharmacoeconomics, Pharmacokinetics, Pharmacology, Toxicology]		●	●
Forest Engineering	⊙			Pharmacy, Doctor of Pharmacy (4-year)			●
Forest Engineering/Civil Engineering	⊙			College of Public Health and Human Sciences			
Forestry [BS options: Forest Landscape Process and Management, Forest Management, Forest Operations Management]	⊙			Kinesiology [BS options: Applied Exercise and Sport Science, Fitness and Nutrition, Physical Education Teacher Education, Pre-Therapy and Allied Health]	⊙	●	●
Natural Resources [BS options: Arid Land Ecology, Ecology Restoration, Fish and Wildlife Conservation, Forest Ecosystems, Geosciences and Natural Resources, Human Dimensions in Natural Resources, Individualized Option, Law Enforcement in Natural Resources, Native Americans and Natural Resources, Natural Resource Education, Natural Resource Policy/Management, Natural Resource Conservation and Technology, Recreation and Tourism Management, Resource Conservation, Sustainable Agroforestry, Urban Forest Landscapes, Watershed Management, Wildland Fire Ecology]	⊙	●		Gerontology (Undergraduate Certificate)		●	
Recreation Resource Management [BS options: Cultural Resource Management, Environmental Resource Interpretation, Forest Resources, Law Enforcement, Park Landscapes, Public Policy, Resource Planning, Sociology, Tourism]	⊙			Human Development and Family Sciences/Studies [BS options: Child Development, Human Development and Family Sciences, Human Services]	⊙	●	●
Renewable Materials [BS options: Art and Design, Management and Marketing, Science and Engineering]	⊙			Human Management and Policy (Graduate Certificate)		●	
Sustainable Forest Management		●	●	Nutrition [BS options: Dietetics, Nutrition and Foodservice Systems, Nutrition and Health Sciences, Pre-Dietetics]	⊙	●	●
Sustainable Natural Resources (Graduate Certificate)		●		Public Health [BS options: Health Management and Policy, Health Promotion and Health Behavior] (Graduate Certificate also available)	⊙	●	●
Tourism and Outdoor Leadership [BS options: Adventure Leadership and Education, Eco and Adventure Tourism, International Ecotourism, Recreation Management] (OSU - Cascades campus only)	⊙			College of Science			
Wood Science		●	●	Biochemistry and Biophysics	⊙	●	●
College of Liberal Arts				Biology [BS options: Ecology, Genetics, Marine Biology, Pre-Dentistry Biology, Pre-Education Biology, Pre-Medicine Biology, Pre-Veterinary Medicine]	⊙		
American Studies (OSU - Cascades campus only)	⊙			Biotechnology (Applied)		●	
Anthropology [BA/BS options: Archaeology, Biocultural, Cultural Linguistics, General Anthropology]	⊙			Chemistry [BA/BS options: Advanced Biochemistry, Advanced Chemistry, Biochemistry, Business, Chemical Engineering, Chemistry Education, Environmental Chemistry, Forensic Science, Materials Science, Pre-Medicine]	⊙	●	●
Applied Anthropology		●	●	BioHealth Sciences [BA/BS options: Pre-Clinical Laboratory Science, Pre-Dentistry, Pre-Medicine, Pre-Nursing Education, Pre-Occupational Therapy, Pre-Optometry, Pre-Pharmacy, Pre-Physical Therapy, Pre-Physician Assistant, Pre-Podiatry]	⊙		
Applied Ethics (Undergraduate Certificate and MA)		●		Mathematics [BS options: Applied and Computational Mathematics, Secondary Teaching Emphasis, Statistics]	⊙	●	●
Applied Visual Arts [B.F.A. options: Fine Arts, Photography]	⊙			Microbiology	⊙	●	●
Art [BA/BS options: Art History, Fine Arts, Photography]	⊙			Molecular and Cellular Biology		●	●
Contemporary Hispanic Studies		●		Physics/Applied Physics [BA/BS options: Applied Physics, Biological Physics, Chemical Physics, Computational Physics, Geophysics, Mathematical Physics, Optical Physics, Physics Education]	⊙	●	●
Creative Writing		●		Statistics		●	●
Digital Communication Arts	⊙			Zoology	⊙	●	●
Economics [BA/BS options: Law, Economics and Policy, Managerial Economics, Mathematical Economics]	⊙			Interdisciplinary			
English	⊙	●		Applied Biotechnology		●	
Ethnic Studies	⊙			College and University Teaching (Graduate Certificate)		●	
Food in Culture and Social Justice (Undergraduate Certificate)		●		Comparative Health Sciences [Options: Biomedical Sciences, Clinical Sciences]		⊙	⊙
French	⊙			Environmental Sciences		●	●
German	⊙			Interdisciplinary Studies		●	
History	⊙			International Studies	⊙		
History of Science		●	●	Sustainability	⊙		
Interdisciplinary Studies		●		College of Veterinary Medicine			
Liberal Studies [BA/BS option: Pre-Education]	⊙			Veterinary Medicine - DVM			●
Medical Humanities (Undergraduate Certificate)		●					
Music [BA/BS options: Instrumental Performance, Music Education, Music Production, Piano Performance, Vocal Performance]	⊙						
Peace Studies (Undergraduate Certificate)		●					
Philosophy	⊙						
Political Science [BA/BS options: Environmental Politics and Policy, International Affairs, Law, Politics and Society]	⊙						
Psychology	⊙						
Public Policy		●	●				
Social Science [BA/BS option: Community Development and Leadership] (OSU - Cascades campus only)	⊙						
Sociology [BA/BS options: Crime and Justice, Environmental and Natural Resource Sociology]	⊙						
Spanish	⊙						
Speech Communication [BA/BS options: Communication, Theater Arts]	⊙						
Women, Gender and Sexuality Studies	⊙	●					

▼ Home of the College of Business: Austin Hall



▼ Inside Kelley Engineering Center

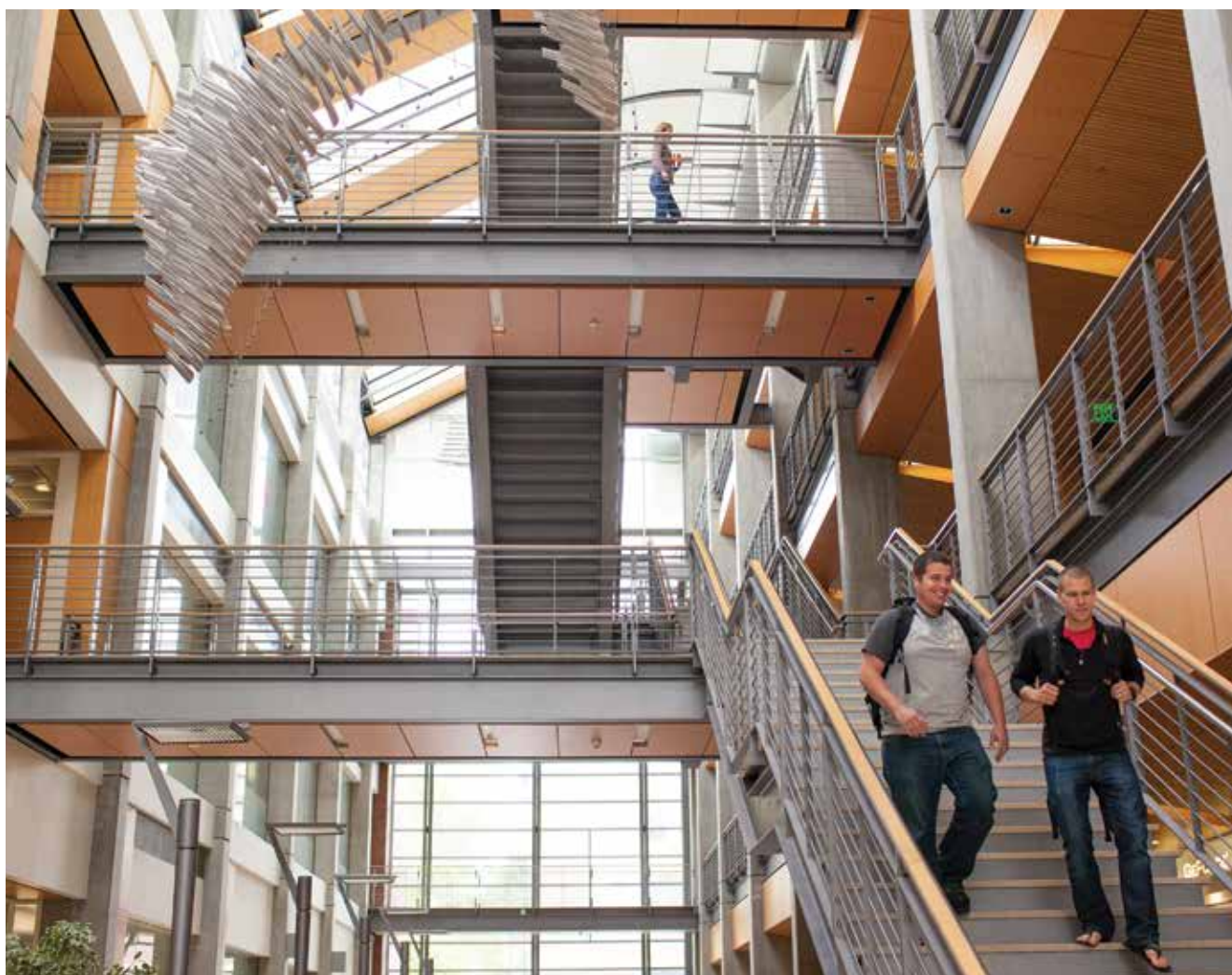

Top-ranked Degree Programs

Through its 11 academic colleges, OSU offers degree programs designed to prepare students for exceptional careers.

Top 100 Universities in the US

in total research and development spending; #17 for research and development spending in environmental sciences. (*The National Science Foundation 2011*)

Turn Ideas into Reality

Join a top-ranked program in Chemical Engineering (#82), Civil Engineering (#43), Nuclear Engineering (#12) and more. (*U.S. News & World Report 2015*)

Power the World's Economy

Earn a degree in Accountancy, Business Administration, Business Information Systems, Finance, Innovation Management, Management, Marketing, Recreation Resource Management, Tourism and Outdoor Leadership or Hospitality Management.

Promote Healthy Lives

Prepare for a career in health sciences by studying Kinesiology, Nutrition, Public Health, Human Development and Family Sciences.

University Honors College

As a small degree-granting college within Oregon State University, the University Honors College offers OSU's most prestigious undergraduate degree—the Honors Baccalaureate—in any undergraduate major.

The UHC community is diverse, supportive and active in the university and the community. The UHC values and embraces a global perspective and welcomes students from all countries and backgrounds. Each year, undergraduate Pathway students have successfully competed to join the UHC.

The UHC Offers:

- Challenging and creative curricula for students of all majors
- Unique classes, typically limited to 12-20 students
- OSU's top professors, often chosen by UHC students
- One-on-one mentoring by faculty members
- An undergraduate thesis where students can pursue their academic and research interests

Admission to the UHC is competitive. Applicants meeting the minimum academic criteria will also be evaluated on their responses to the essay portion of the UHC application and on their non-academic activities and contributions to their communities.

For more information about the UHC, visit: honors.oregonstate.edu

Academic Colleges

To learn more about the academic colleges, please visit the websites listed below.

College of Agricultural Sciences
agsci.oregonstate.edu

College of Business
business.oregonstate.edu

**College of Earth, Ocean
and Atmospheric Sciences**
ceoas.oregonstate.edu

College of Education
education.oregonstate.edu

College of Engineering
engineering.oregonstate.edu

College of Forestry
forestry.oregonstate.edu

College of Liberal Arts
liberalarts.oregonstate.edu

College of Pharmacy
pharmacy.oregonstate.edu

**College of Public Health and
Human Sciences**
health.oregonstate.edu

College of Science
science.oregonstate.edu

College of Veterinary Medicine
vetmed.oregonstate.edu



“At INTO OSU, we are proud to offer truly world-class English language and Pathway programs. We achieve high levels of student satisfaction by providing the support and services that students need for personal and academic success.”

Bob Gilmour
Executive Director
INTO Oregon State University



91%

of students are satisfied with INTO OSU support services

92%

of Accelerated Graduate Pathway students have successfully progressed to an OSU graduate degree

INTO Oregon State University

Students studying at INTO OSU have all the benefits and experiences of campus life at an American university. Along with living and learning in the heart of the OSU campus, students will develop friendships with American and international students and have access to all of the academic, social and cultural resources and activities at Oregon State University.

Welcome to INTO Oregon State University

At INTO OSU, international students join a supportive community committed to helping students integrate with ease into American university life while preparing them for degree studies. Since welcoming our first class in September 2009, INTO OSU has helped over 3,500 international students from more than 50 countries improve their academic and English language skills.

The INTO OSU Advantage

- Take the first steps toward earning a US university degree at one of America's top-ranked research universities.
- Live and learn with university students from all 50 US states and more than 100 countries.
- Enjoy full access to all university resources, services and facilities.
- Learn in small classes taught by university instructors.
- Earn academic credits that apply toward OSU degree programs.
- Receive personalized academic advising throughout any program of study.
- Progress to an OSU degree program upon successful completion of a Pathway program.

State-of-the-art Facilities

The International Living-Learning Center opened its doors in September 2011, bringing international and domestic students together to live and learn in the heart of the OSU campus. The ILLC includes residential accommodations for more than 300 students, 26 classrooms, a large auditorium, computer labs, a café, market and comfortable open spaces where students can study or socialize.

Center Facilities Include:

- Close proximity to all campus facilities
- A café and market with offerings that cater to international students' needs
- A learning resource center and multi-purpose classrooms equipped with interactive white boards
- Free wireless internet and several computer labs available for student use
- Lounges for studying, a kitchen on every floor and a pool table
- Fun, comfortable furniture with televisions in every lounge
- Personalized support services, including 24-hour emergency assistance

Programs Offered

Undergraduate Pathway Programs

Accelerated Pathway Programs (leads to all majors)

- 1-term and 2-term Accelerated (page 23)

3-term Standard Pathway Programs

- Business (page 23)
- Computer Science (page 24)
- Engineering (page 24)
- Exercise and Sport Science (page 25)
- Food Science and Technology (page 25)
- Forestry (page 26)
- General, General-Liberal Arts Focus (page 26)
- Natural Resources and Renewable Materials (page 27)
- Public Policy (page 27)
- Science (page 28)
- Women and Gender Studies (page 28)

Graduate Pathway Programs

Accelerated Pathway Programs

- 1-term Accelerated MEng (page 38)
- 2-term Accelerated MBA (page 37)

3-term Standard Pathway Programs

- Business (MBA) (page 37)
- Engineering (MEng) (page 38-42)
- Comparative Health Sciences (MS/PhD) (page 43)

English Language Program

- Academic English (page 46)
- General English (page 47)
- Study Abroad with English (page 48)
- Visiting International Student Program (page 49)

86%

of students are satisfied with their INTO OSU living conditions

Our Mission

INTO OSU provides international students with learning experiences and services that promote academic, professional and personal success



#113

Best Undergraduate Business
Program in the US
(U.S. News & World Report 2015)

Undergraduate



Former Undergraduate
Pathway students
perform as well as direct
international students



#73

Best Undergraduate Engineering
Program in the US
(U.S. News & World Report 2015)

Undergraduate Direct Entry

OSU provides direct admission to the university for international first-year and transfer students. Applicants must meet minimum English language proficiency and GPA requirements. Admission decisions are made on a rolling basis with four entry dates.

1. Apply for Admission

Before starting your application make sure you meet our admissions requirements on page 19.

To apply visit: intlapps.oregonstate.edu

2. Submit Transcripts and Test Scores

- Send your official transcripts from all secondary and post-secondary institutions attended.
- In order to expedite application processing, you can submit unofficial copies of transcripts until official transcripts arrive.
- Please ensure that all documents issued in languages other than English are accompanied by a certified English translation.

3. Submit Immigration Documents

- A copy of your passport
- A financial statement that shows funding support based on the estimated cost of attendance for one academic year
- An OSU Affidavit of Support

4. Check Your Application Status

Processing times vary. We will notify you of any missing documents required. If you have any questions regarding your application, please send an email to intladmit@oregonstate.edu

Start Dates for OSU Degree Programs

Term	Start Dates	Undergraduate Application Deadline	Application Fee
Fall 2016	September 13, 2016	August 24, 2016	\$60
Winter 2017	January 5, 2017	December 9, 2016	\$60
Spring 2017	March 30, 2017	March 6, 2017	\$60
Summer 2017	June 23, 2017	May 29, 2017	\$60

5. Finalize Your Plans

If admitted to OSU, you will receive:

- Electronic notification of your admission containing a Letter of Offer
- Information about the next steps you'll take

After you have confirmed your admission by returning the signed Letter of Offer, you will receive an admission packet containing:

- A letter of admission
- An OSU I-20 (F-1 visa) or DS-2019 (J-1 visa)
- An OSU Pre-Departure Guide

6. Document Submission

All application documentation (official transcripts and financial statements, etc.) must be sent to:

Oregon State University
Office of International Admissions
1701 SW Western Boulevard
Corvallis, OR 97333
USA

T: +1 541 737 2464

F: +1 541 737 4220

E: intladmit@oregonstate.edu

Credit-by-Exam

OSU recognizes the achievement of AP, AS and A Level, IB, CLEP, Vitnemal, Abitur and CAPE scholars. You may be eligible for advanced academic standing and scholarships, and can receive transfer credit for the exams, courses and subjects you have taken.

Visit: oregonstate.edu/admissions/international/credit-articulation-tables

Academic and English Testing Score Codes for OSU

SAT: 4586 TOEFL: 4586

ACT: 3482 IELTS: DIRECT

Third-party Authorization

If a family member or educational counselor is completing the application on your behalf and you would like for OSU to communicate with them regarding your application, please complete the form at the following link: oregonstate.edu/admissions/international/third-party-authorization-form and submit to intladmit@oregonstate.edu

Double Degrees

At Oregon State University, undergraduate students have the opportunity to graduate with a double degree. For each additional degree, a student must complete a minimum of 32 credits above the minimum number of credits needed for one degree. The student will also receive a separate diploma for each degree awarded.

International Double Degree

The International double-degree is designed to take the education abroad experience further through advanced language proficiency, increased cultural awareness and a comprehensive analysis of international reach of academic study.

Sustainability Double Degree

The Sustainability double-degree provides students with a rich interdisciplinary education to address the growing demand for socially and environmentally responsible products and services, and to face global and local problems such as climate change, biodiversity loss, social inequities, and water and food scarcity. Sustainability is also available as a minor.

Key Program Facts

Start Dates

- Fall: September 13, 2016
- Winter: January 5, 2017
- Spring: March 30, 2017
- Summer: June 23, 2017

Direct Entry

- 3.0 GPA with high school diploma or equivalent
- No SAT **or** ACT required for international students

English Language Requirements

- TOEFL iBT 80 (minimum 16 subscores) (PBT 550) **or**
- IELTS 6.5 **or**
- Completion of Academic English Level 6 with C (or Pass) or higher grades in all classes **or**
- SATV (verbal/critical thinking): 500+ **or**
- ACTE (ACT English): 21+

Transfer Admission

Academic Entry Requirements

- Have earned 36 or more quarter transferable credits (24 semester credits)
- 2.5 GPA cumulative if transferring from a recognized college or university outside the United States
- 2.25 GPA cumulative if transferring from a regionally accredited college or university in the US **and** a grade of C- or better earned in college-level writing equivalent to WR 121 (English Composition) and Mathematics with course content of College Algebra
- Eligible to return to the most recent institution attended

English Language Requirements

- TOEFL iBT 80 (minimum 16 subscores) (PBT 550) **or**
- IELTS 6.5

oregonstate.edu/admissions/international



Undergraduate Pathway Programs

Our Undergraduate Pathway programs are designed to help international students move successfully through the first year of their undergraduate degree at OSU, providing extra support in and out of the classroom.

Understand the Pathway Program

Our Undergraduate Pathway programs combine intensive English language study, academic skills development and academic course work. The carefully constructed programs are designed to move students successfully through the first year of an undergraduate degree program. Pathway programs do not extend the overall length of an undergraduate degree program. In fact, Pathway programs guarantee places in required courses, which may prevent extension of program length.

Decide if the Program is Right for You

The Pathway program is designed for students who want extra support and preparation for OSU's rigorous degree programs. The program is ideal for students who:

- Want to earn a bachelor's degree in the US
- Desire additional academic, language and cultural support to excel at a US university
- May need to improve English language skills
- May have a lower GPA than required for direct admission to degree programs

Program Benefits

- Guaranteed progression to an OSU undergraduate program upon successful completion of a Pathway program
- Courses with domestic and international students
- Access to all OSU campus facilities and events
- Highly-trained, experienced university instructors
- Dedicated Undergraduate Pathway tutoring for any subject
- Academic advising throughout the program including progression and student success advisors
- Use of a state-of-the-art learning center
- Exceptional on-campus housing experience (all students with Undergraduate Pathway in their study plan are required to live on campus during their first three terms)

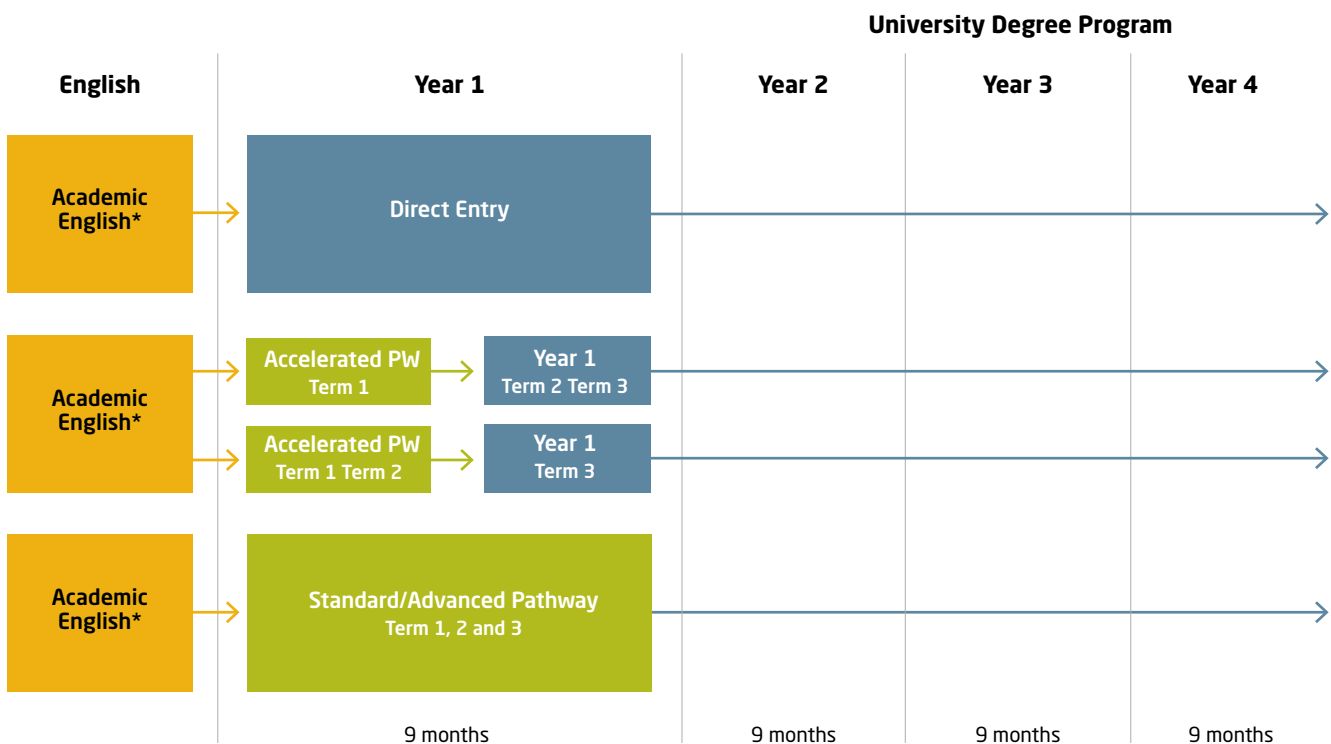

*If Academic English is needed, the length of the program will depend on language proficiency.

Pathway Options

3-Term Standard Pathway

Provides an excellent balance of academic and English language preparation. This is ideal for most students.

1-Term or 2-Term Accelerated Pathway

This option is great for students with good academic grades who need little or no English preparation.

Note: Engineering Pathway students are encouraged to take a 3-term Standard Pathway program.

Math Placement for Undergraduate Pathway Students

All undergraduate Pathway students are required to take the OSU Math Placement Test during orientation week. This test will place the student in the most suitable math class.

You will have the opportunity to take the free, online OSU Math Placement Test in your home country before arriving on campus. You can take the test in the six-month period before your Undergraduate Pathway program begins. After taking the test, you will have access to free, online math study materials for a period of six months. The materials are specifically designed to help you increase your math skills.

If you are completing the INTO OSU Academic English program prior to your Undergraduate Pathway program, or if you do not take the test prior to arrival at OSU to begin your Undergraduate Pathway Program, you will take the OSU Math Placement Test in the INTO OSU Center during orientation week.

Key Program Facts

Start Dates*

- Fall: September 13, 2016
- Winter: January 3, 2017
- Spring: March 27, 2017

* Students must arrive at least one day prior to the program start date.

Entry Requirements

3-Term Standard Pathway

- High school diploma with a 2.5 GPA
- TOEFL iBT 60 (PBT 500) **or** IELTS 5.5 **or** PTEA 44 **or** Password overall Level 6 **or** completion of Academic English Level 4
- Students with English scores equal or higher to TOEFL iBT 70 (PBT 525) **or** IELTS 6 **or** PTEA 48 **or** Password overall Level 7 **or** completion of Academic English Level 5 will be automatically enrolled in an Advanced Pathway Program with fewer English language classes and more academic classes.

2-Term Accelerated Pathway

- High school diploma with a 3.0 GPA
- TOEFL iBT 70 (PBT 525) **or** IELTS 6.0 **or** completion of Academic English Level 5

1-Term Accelerated Pathway

- High school diploma with a 3.0 GPA
- TOEFL iBT 75 (minimum 16 subscores) (PBT 540) **or** IELTS 6.0 (minimum 5.5 subscores) **or** completion of Academic English Level 6

Age Requirement

- 16 years old

Minimum Progression Requirements to OSU

Undergraduate Study

- 2.25 GPA cumulative in the Pathway program
- No Satisfactory/Unsatisfactory (S/U) grades in academic course work
- All students must have a minimum grade of C- in English Composition (WR 121), Math (MTH 111 or higher) and Public Speaking (COMM 111)
- Minimum of 12 credits per Pathway term

Program Notes

- Academically qualified students who are unable to provide a language proficiency score, or one that is below the minimum, will be offered Academic English and conditional admission to the Pathway.

intohigher.com/osu/ugpw



Undergraduate Pathway Programs

Progression to the following undergraduate degrees may be granted upon successful completion of an Undergraduate Pathway.

Business

Accountancy
Apparel Design
Agricultural Business Management
Business Administration
Business Information Systems
Finance
Graphic Design
Interior Design
Management
Marketing
Merchandising Management

Computer Science

Computer Science

Engineering

Bioengineering
Civil Engineering
Construction Engineering Management
Ecological Engineering
Electrical and Computer Engineering
Energy Systems Engineering
Environmental Engineering
Forest Engineering/Civil Engineering
Industrial Engineering
Manufacturing Engineering
Mechanical Engineering
Nuclear Engineering

Exercise and Sport Science

Kinesiology
Human Development in Family Sciences
Nutrition
Public Health

Food Science and Technology

Food Science and Technology

Forestry*

Forestry
Forestry Engineering

General and General Liberal Arts Focus

American Studies
Anthropology
Applied Visual Arts
Art
Digital Communication Arts
Education
English
Ethnic Studies
French

General and General Liberal Arts (continued)

German
History
Liberal Studies
Music
Philosophy
Political Science
Psychology
Social Science
Spanish
Speech Communication
All other majors**

Public Policy

Economics
Environmental Economics and Policy
Sociology

Natural Resources and Renewable Materials*

Horticulture
Natural Resources
Rangeland Sciences
Recreation Resource Management
Renewable Materials
Tourism and Outdoor Leadership

Science

Agricultural Sciences
Animal Sciences
Biochemistry and Biophysics
Biohealth Sciences
Biology
Bioresource Research
Botany
Chemistry
Crop and Soil Science
Earth Sciences
Environmental Sciences
Fisheries and Wildlife Sciences
Mathematics
Microbiology
Physics/Applied Physics
Radiation Health Physics
Zoology

Women and Gender Studies

Women, Gender and Sexuality Studies

*The Forestry and Natural Resources and Renewable Materials Pathway can lead to the indicated major but may require some additional course work.

**For full list of majors and options please refer to pages 10-11.

Accelerated Pathway Programs for Undergraduate Majors (All Programs)			
1-Term Accelerated Pathway	Degree Program Components		Program Information
Fall: September 13, 2016 Winter: January 3, 2017 Spring: March 27, 2017	180 credit hour program 17 credit hours apply from Pathway 163 credit hours remaining toward degree		
Entry Requirements	Term 1	Course Title	Credit Hours
Academic Requirements	WR 121	English Composition	3
• High school diploma with a 3.0 GPA	ALS 181	English Composition Bridge	2
Language Requirements	COMM 111	Public Speaking	3
• TOEFL iBT 75 (minimum 16 subscores) (PBT 540) or	MTH	Math Course - Variable Level*	4
• IELTS 6.0 (minimum 5.5 subscores) or	ANTH 210	Comparative Cultures	3
• Completion of Academic English Level 6 with C (or Pass) or higher grades in all classes	ALS 181	Comparative Cultures Bridge	2
	Total		17
2-Term Accelerated Pathway	Degree Program Components		Progression Requirements
Fall: September 13, 2016 Winter: January 3, 2017 Spring: March 27, 2017	180 credit hour program 32 credit hours apply from Pathway 148 credit hours remaining toward degree		<ul style="list-style-type: none"> 2.25 GPA cumulative in the Pathway program No Satisfactory/Unsatisfactory (S/U) graded courses in OSU academic course work Grade of C- or better in English Composition (WR 121), Math (MTH 111, MTH 105 or higher) and Communication (COMM 111) For the 1-term Accelerated Pathway: Minimum of 12 credits earned during the Pathway program For the 2-Term Accelerated Pathway: Minimum of 24 credits earned during the Pathway program
Entry Requirements	Term 1	Course Title	Credit Hours
Academic Requirements	ALS 162	Academic Reading/Writing	3
• High school diploma with a 3.0 GPA	ALS 161	Academic Listening/Speaking	3
Language Requirements	HHS 231	Lifetime Fitness for Health	2
• TOEFL iBT 70 (PBT 525) or	ALS 181	Lifetime Fitness for Health Bridge	2
• IELTS 6.0 or	PAC	Physical Activity Class	1
• Completion of Academic English Level 5 with C (or Pass) or higher grades in all classes	MTH	Math Course - Variable Level*	4
	Total		15
	Term 2	Course Title	Credit Hours
	WR 121	English Composition	3
	ALS 181	English Composition Bridge	2
	COMM 111	Public Speaking	3
	MTH	Math Course - Variable Level*	4
	ANTH 210	Comparative Cultures	3
	ALS 181	Comparative Cultures Bridge	2
	Total		17

Notes
* Specific course is determined by results of Math placement test and requirements for the major field of study.
These courses are generally delivered through the INTO OSU Center and are for Pathway students only.

oregonstate.edu/main/academics

Business			
3-Term Standard Pathway	Degree Program Components		Program Information
Fall: September 13, 2016 Winter: January 3, 2017 Spring: March 27, 2017	180 credit hour program 47 credit hours apply from Pathway 133 credit hours remaining toward degree		
Entry Requirements	Term 1	Course Title	Credit Hours
Academic Requirements	ALS 150	Academic Reading/Writing	3
• High school diploma with a 2.5 GPA	ALS 151	Academic Listening/Speaking	3
Language Requirements	MTH	Math Course - Variable Level*	4
• TOEFL iBT 60 (PBT 500) or	HHS 231	Lifetime Fitness for Health	2
• IELTS 5.5 or	ALS 181	Lifetime Fitness for Health Bridge	2
• PTEA 44+ or	PAC	Physical Activity Class	1
• Password overall level 6 or	Total		15
• Completion of Academic English Level 4 with C (or Pass) or higher grades in all classes	Term 2	Course Title	Credit Hours
	ALS 162	Academic Reading/Writing	3
	COMM 111	Public Speaking	3
	MTH	Math Course - Variable Level*	4
	ANTH 210	Comparative Cultures	3
	ALS 181	Comparative Culture Bridge	2
	Total		15
	Term 3	Course Title	Credit Hours
	WR 121	English Composition	3
	ALS 181	English Composition Bridge	2
	MTH	Math Course - Variable Level*	4
	BA 101	Business Now	6
	ALS 181	Business Now Bridge	2
	Total		17
	Term 4	(Optional)	

Notes
* Specific course is determined by results of Math placement test and requirements for the major field of study.

Term 4 (Optional)
* During the fourth term students can complete additional classes to ensure that they are well prepared for their second year at OSU and on track to complete in 4 years.
These courses are generally delivered through the INTO OSU Center and are for Pathway students only.

business.oregonstate.edu

Undergraduate Pathway Programs

Computer Science				
3-Term Standard Pathway	Degree Program Components		Program Information	
Fall: September 13, 2016	180 credit hour program 47 credit hours apply from Pathway 133 credit hours remaining toward degree			
Entry Requirements	Term 1	Course Title	Credit Hours	
Academic Requirements <ul style="list-style-type: none"> High school diploma with a 2.5 GPA Language Requirements <ul style="list-style-type: none"> TOEFL iBT 60 (PBT 500) or IELTS 5.5 or PTEA 44+ or Password overall level 6 or Completion of Academic English Level 4 with C (or Pass) or higher grades in all classes 	ALS 150	Academic Reading/Writing	3	
	ALS 151	Academic Listening/Speaking	3	
	MTH	Math Course - Variable Level*	4	
	CS 160	Computer Science Orientation	3	
	ALS 181	Computer Science Orientation Bridge	2	
	Total			15
	Term 2	Course Title	Credit Hours	
	ALS 162	Academic Reading/Writing	3	
	COMM 111	Public Speaking	3	
	MTH	Math Course - Variable Level*	4	
	EECS 161	Introduction to Computer Science I	4	
	PAC	Physical Activity Class	1	
	Total			15
	Term 3	Course Title	Credit Hours	
	WR 121	English Composition	3	
	ALS 181	English Composition Bridge	2	
	MTH	Math Course - Variable Level*	4	
EECS 162	Introduction to Computer Science II	4		
HHS 231	Lifetime Fitness for Health	2		
ALS 181	Lifetime Fitness for Health Bridge	2		
Total			17	
Term 4	(Recommended)			
	Progression Requirements			
	<ul style="list-style-type: none"> 2.25 GPA cumulative in the Pathway program No Satisfactory/Unsatisfactory (S/U) graded courses in OSU academic course work Grade of C- or better in English Composition (WR 121), Math (MTH 111 or higher) and Communication (COMM 111) Minimum of 36 credits earned during Pathway program 			
	Notes			
	* Specific course is determined by results of Math placement test and requirements for the major field of study.			
	Term 4 (Recommended)			
	During the fourth term students will complete the additional classes to ensure that they are well prepared for their second year at OSU. It is recommended that all students, especially those in sciences and engineering, plan to study for four consecutive terms.			
	These courses are generally delivered through the INTO OSU Center and are for Pathway students only.			

eeecs.oregonstate.edu

Engineering				
3-Term Standard Pathway	Degree Program Components		Program Information	
Fall: September 13, 2016 Winter: January 3, 2017	180 credit hour program 49 credit hours apply from Pathway 131 credit hours remaining toward degree			
Entry Requirements	Term 1	Course Title	Credit Hours	
Academic Requirements <ul style="list-style-type: none"> High school diploma with a 2.5 GPA Language Requirements <ul style="list-style-type: none"> TOEFL iBT 60 (PBT 500) or IELTS 5.5 or PTEA 44+ or Password overall level 6 or Completion of Academic English Level 4 with C (or Pass) or higher grades in all classes 	ALS 150	Academic Reading/Writing	3	
	ALS 151	Academic Listening/Speaking	3	
	MTH	Math Course - Variable Level*	4	
	ENGR 111	Engineering Orientation I	3	
	ALS 181	Engineering Orientation I Bridge	2	
	Total			15
	Term 2	Course Title	Credit Hours	
	ALS 162	Academic Reading/Writing	3	
	MTH	Math Course - Variable Level*	4	
	CH 231	General Chemistry + Lab	5	
	ENGR 112	Engineering Orientation II	3	
	ALS 181	Engineering Orientation II Bridge	2	
	Total			17
	Term 3	Course Title	Credit Hours	
	WR 121	English Composition	3	
	ALS 181	English Composition Bridge	2	
	COMM 111	Public Speaking	3	
MTH	Math Course - Variable Level*	4		
CH 232	General Chemistry + Lab	5		
Total			17	
Term 4	(Recommended)			
	Progression Requirements			
	<ul style="list-style-type: none"> 2.25 GPA cumulative in the Pathway program No Satisfactory/Unsatisfactory (S/U) graded courses in OSU academic course work Grade of C- or better in English Composition (WR 121), Math (MTH 111 or higher) and Communication (COMM 111) Minimum of 36 credits earned during Pathway program 			
	Notes			
	* Specific course is determined by results of Math placement test and requirements for the major field of study.			
	Term 4 (Recommended)			
	During the fourth term students will complete the additional classes to ensure that they are well prepared for their second year at OSU. It is recommended that all students, especially those in sciences and engineering, plan to study for four consecutive terms.			
	These courses are generally delivered through the INTO OSU Center and are for Pathway students only.			

engineering.oregonstate.edu

Exercise and Sport Science			
3-Term Standard Pathway	Degree Program Components		Program Information
Fall: September 13, 2016 Winter: January 3, 2017 Spring: March 27, 2017	180 credit hour program 50 credit hours apply from Pathway 130 credit hours remaining toward degree		
Entry Requirements	Term 1	Course Title	Credit Hours
Academic Requirements	ALS 150	Academic Reading/Writing	3
• High school diploma with a 2.5 GPA	ALS 151	Academic Listening/Speaking	3
Language Requirements	MTH	Math Course - Variable Level*	4
• TOEFL iBT 60 (PBT 500) or	EXSS 131	Introduction to Exercise and Sport Science	1
• IELTS 5.5 or	CH 121	General Chemistry	5
• PTEA 44+ or	Total		16
• Password overall level 6 or	Term 2	Course Title	Credit Hours
• Completion of Academic English Level 4 with C (or Pass) or higher grades in all classes	ALS 162	Academic Reading/Writing	3
	COMM 111	Public Speaking	3
	ANTH 210	Comparative Cultures	3
	ALS 181	Comparative Cultures Bridge	2
	CH 122	General Chemistry	5
	Total		16
	Term 3	Course Title	Credit Hours
	WR 121	English Composition	3
	ALS 181	English Composition Bridge	2
	MTH	Math Course - Variable Level*	4
	HHS 231	Lifetime Fitness for Health	2
	ALS 181	Lifetime Fitness for Health Bridge	2
	CH 123	General Chemistry	5
	Total		18
	Term 4	(Optional)	

Progression Requirements

- 2.25 GPA cumulative in the Pathway program
- No Satisfactory/Unsatisfactory (S/U) graded courses in OSU academic course work
- Grade of C- or better in English Composition (WR 121), Math (MTH 111 or higher) and Communication (COMM 111)
- Minimum of 36 credits earned during Pathway program

Notes

* Specific course is determined by results of Math placement test and requirements for the major field of study.

Term 4 (Optional)

During the fourth term students can complete additional classes to ensure that they are well prepared for their second year at OSU and on track to complete in 4 years.

These courses are generally delivered through the INTO OSU Center and are for Pathway students only.

health.oregonstate.edu/degrees/kinesiology

Food Science and Technology			
3-Term Standard Pathway	Degree Program Components		Program Information
Fall: September 13, 2016 Winter: January 3, 2017 Spring: March 27, 2017	180 credit hour program 47 credit hours apply from Pathway 133 credit hours remaining toward degree		
Entry Requirements	Term 1	Course Title	Credit Hours
Academic Requirements	ALS 150	Academic Reading/Writing	3
• High school diploma with a 2.5 GPA	ALS 151	Academic Listening/Speaking	3
Language Requirements	MTH	Math Course - Variable Level*	4
• TOEFL iBT 60 (PBT 500) or	FST 101	Food Science Orientation	1
• IELTS 5.5 or	HHS 231	Lifetime Fitness for Health	2
• PTEA 44+ or	ALS 181	Lifetime Fitness for Health Bridge	2
• Password overall level 6 or	Total		15
• Completion of Academic English Level 4 with C (or Pass) or higher grades in all classes	Term 2	Course Title	Credit Hours
	ALS 162	Academic Reading/Writing	3
	FST 273	Wine in the Western World	3
	MTH	Math Course - Variable Level*	4
	CH 231	General Chemistry + Lab	5
	Total		15
	Term 3	Course Title	Credit Hours
	WR 121	English Composition	3
	ALS 181	English Composition Bridge	2
	MTH	Math Course - Variable Level*	4
	COMM 111	Public Speaking	3
	CH 232	General Chemistry + Lab	5
	Total		17
	Term 4	(Recommended)	

Progression Requirements

- 2.25 GPA cumulative in the Pathway program
- No Satisfactory/Unsatisfactory (S/U) graded courses in OSU academic course work
- Grade of C- or better in English Composition (WR 121), Math (MTH 111 or higher) and Communication (COMM 111)
- Minimum of 36 credits earned during Pathway program

Notes

* Specific course is determined by results of Math placement test and requirements for the major field of study.

Term 4 (Recommended)

During the fourth term students will complete the additional classes to ensure that they are well prepared for their second year at OSU. It is recommended that all students, especially those in sciences and engineering, plan to study for four consecutive terms.

These courses are generally delivered through the INTO OSU Center and are for Pathway students only.

oregonstate.edu/foodsci

Undergraduate Pathway Programs

Forestry			
3-Term Standard Pathway	Degree Program Components		Program Information
Fall: September 13, 2016 Winter: January 3, 2017	180 credit hour program 47 credit hours apply from Pathway 133 credit hours remaining toward degree		
Entry Requirements	Term 1	Course Title	Credit Hours
Academic Requirements	ALS 150	Academic Reading and Writing	3
• High school diploma with a 2.5 GPA	ALS 151	Academic Listening and Speaking	3
Language Requirements	MTH	Math Course - Variable Level*	4
• TOEFL iBT 60 (PBT 500) or	HHS 231	Lifetime Fitness for Health	2
• IELTS 5.5 or	ALS 181	Lifetime Fitness for Health Bridge	2
• PTEA 44+ or	PAC	Physical Activity Class	1
• Password overall level 6 or	Total		15
• Completion of Academic English Level 4 with C (or Pass) or higher grades in all classes	Term 2	Course Title	Credit Hours
	ALS 162	University Reading and Writing	3
	CH 231	General Chemistry + Lab	5
	MTH	Math Course - Variable Level*	4
	COMM 111	Public Speaking	3
	Total		15
	Term 3	Course Title	Credit Hours
	WR 121	English Composition	3
	ALS 181	English Composition Bridge	2
	MTH	Math Course - Variable Level*	4
	FES 241	Dendrology	5
	FOR 111	Intro to Forestry	3
	Total		17
	Term 4	(Recommended)	
	Progression Requirements		
	<ul style="list-style-type: none"> • 2.25 GPA cumulative in the Pathway program • No Satisfactory/Unsatisfactory (S/U) graded courses in OSU academic course work • Grade of C or better in English Composition (WR 121), Math (MTH 111 or higher) and Communication (COMM 111) • Minimum of 36 credits earned during Pathway program 		
	Notes		
	* Specific course is determined by results of Math placement test and requirements for the major field of study.		
	Term 4 (Recommended)		
	During the fourth term students will complete the additional classes to ensure that they are well prepared for their second year at OSU. It is recommended that all students, especially those in sciences and engineering, plan to study for four consecutive terms.		
	These courses are generally delivered through the INTO OSU Center and are for Pathway students only.		

forestry.oregonstate.edu

General and General Liberal Arts			
3-Term Standard Pathway	Degree Program Components		Program Information
Fall: September 13, 2016 Winter: January 3, 2017 Spring: March 27, 2017	180 credit hour program 47 credit hours apply from Pathway 133 credit hours remaining toward degree		
Entry Requirements	Term 1	Course Title	Credit Hours
Academic Requirements	ALS 150	Academic Reading/Writing	3
• High school diploma with a 2.5 GPA	ALS 151	Academic Listening/Speaking	3
Language Requirements	MTH	Math Course - Variable Level*	4
• TOEFL iBT 60 (PBT 500) or	HHS 231	Lifetime Fitness for Health	2
• IELTS 5.5 or	ALS 181	Lifetime Fitness for Health Bridge	2
• PTEA 44+ or	PAC	Physical Activity Class	1
• Password overall level 6 or	Total		15
• Completion of Academic English Level 4 with C (or Pass) or higher grades in all classes	Term 2	Course Title	Credit Hours
	ALS 162	Academic Reading/Writing	3
	COMM 111	Public Speaking	3
	ES 101	Introduction to Ethnic Studies	3
	ANTH 210	Comparative Cultures	3
	ALS 181	Comparative Cultures Bridge	2
	Total		14
	Term 3	Course Title	Credit Hours
	WR 121	English Composition	3
	ALS 181	English Composition Bridge	2
	HST 201	History of the United States	4
	ALS 181	History of the United States Bridge	2
	ECON 201	Introduction to Microeconomics	4
	MUS 108	Music Cultures of the World	3
	Total		18
	Term 4	(Optional)	
	Progression Requirements		
	<ul style="list-style-type: none"> • 2.25 GPA cumulative in the Pathway program • No Satisfactory/Unsatisfactory (S/U) graded courses in OSU academic course work • Grade of C- or better in English Composition (WR 121), Math (MTH 111, MTH 105 or higher) and Communication (COMM 111) • Minimum of 36 credits earned during Pathway program 		
	Notes		
	* Specific course is determined by results of Math placement test and requirements for the major field of study.		
	Term 4 (Optional)		
	During the fourth term students can complete additional classes to ensure that they are well prepared for their second year at OSU and on track to complete in 4 years.		
	These courses are generally delivered through the INTO OSU Center and are for Pathway students only.		

liberalarts.oregonstate.edu

Natural Resources and Renewable Materials			
3-Term Standard Pathway	Degree Program Components		Program Information
Fall: September 13, 2016 Winter: January 3, 2017 Spring: March 27, 2017	180 credit hour program 46 credit hours apply from Pathway 134 credit hours remaining toward degree		
Entry Requirements	Term 1	Course Title	Credit Hours
Academic Requirements	ALS 150	Academic Reading/Writing	3
• High school diploma with a 2.5 GPA	ALS 151	Academic Listening/Speaking	3
Language Requirements	MTH	Math Course - Variable Level*	4
• TOEFL iBT 60 (PBT 500) or	HHS 231	Lifetime Fitness for Health	2
• IELTS 5.5 or	ALS 181	Lifetime Fitness for Health Bridge	2
• PTEA 44+ or	PAC	Physical Activity Class	1
• Password overall level 6 or	Total		15
• Completion of Academic English Level 4 with C (or Pass) or higher grades in all classes	Term 2	Course Title	Credit Hours
	ALS 162	Academic Reading/Writing	3
	MTH	Math Course - Variable Level*	4
	NR 201	Managing Natural Resources for the Future	3
	ALS 181	Managing Natural Resources for the Future Bridge	2
	WSE 111	Renewable Materials for a Green Planet	2
	Total		14
	Term 3	Course Title	Credit Hours
	WR 121	English Composition	3
	ALS 181	English Composition Bridge	2
	MTH	Math Course - Variable Level*	4
	COMM 111	Public Speaking	3
	SUS 102	Introduction to Environmental Science and Sustainability	3
	ALS 181	Introduction to Environmental Science and Sustainability	2
	Total		15
	Term 4	(Optional)	
	Progression Requirements		<ul style="list-style-type: none"> • 2.25 GPA cumulative in the Pathway program • No Satisfactory/Unsatisfactory (S/U) graded courses in OSU academic course work • Grade of C- or better in English Composition (WR 121), Math (MTH 111 or higher) and Communication (COMM 111) • Minimum of 36 credits earned during Pathway program
	Notes		* Specific course is determined by results of Math placement test and requirements for the major field of study.
	Term 4 (Optional)		During the fourth term students can complete additional classes to ensure that they are well prepared for their second year at OSU and on track to complete in 4 years. These courses are generally delivered through the INTO OSU Center and are for Pathway students only.

oregonstate.edu/cia/spp

Public Policy			
3-Term Standard Pathway	Degree Program Components		Program Information
Fall: September 13, 2016 Winter: January 3, 2017 Spring: March 27, 2017	180 credit hour program 45 credit hours apply from Pathway 135 credit hours remaining toward degree		
Entry Requirements	Term 1	Course Title	Credit Hours
Academic Requirements	ALS 150	Academic Reading/Writing	3
• High school diploma with a 2.5 GPA	ALS 151	Academic Listening/Speaking	3
Language Requirements	MTH	Math Course - Variable Level*	4
• TOEFL iBT 60 (PBT 500) or	HHS 231	Lifetime Fitness for Health	2
• IELTS 5.5 or	ALS 181	Lifetime Fitness for Health Bridge	2
• PTEA 44+ or	PAC	Physical Activity Class	1
• Password overall level 6 or	Total		15
• Completion of Academic English Level 4 with C (or Pass) or higher grades in all classes	Term 2	Course Title	Credit Hours
	ALS 162	Academic Reading/Writing	3
	COMM 111	Public Speaking	3
	SOC 204	Introduction to Sociology	3
	ALS 181	Introduction to Sociology Bridge	2
	ECON 201	Introduction to Microeconomics	4
	Total		15
	Term 3	Course Title	Credit Hours
	WR 121	English Composition	3
	ALS 181	English Composition Bridge	2
	PS 201	United States Government and Politics	4
	ALS 181	United States Government and Politics Bridge	2
	ECON 202	Introduction to Macroeconomics	4
	Total		15
	Term 4	(Optional)	
	Progression Requirements		<ul style="list-style-type: none"> • 2.25 GPA cumulative in the Pathway program • No Satisfactory/Unsatisfactory (S/U) graded courses in OSU academic course work • Grade of C- or better in English Composition (WR 121), Math (MTH 111, MTH 105 or higher) and Communication (COMM 111) • Minimum of 36 credits earned during Pathway program
	Notes		* Specific course is determined by results of Math placement test and requirements for the major field of study.
	Term 4 (Optional)		During the fourth term students can complete additional classes to ensure that they are well prepared for their second year at OSU and on track to complete in 4 years. These courses are generally delivered through the INTO OSU Center and are for Pathway students only.

oregonstate.edu/cia/spp

Undergraduate Pathway Programs

Science				
3-Term Standard Pathway	Degree Program Components			Program Information
Fall: September 13, 2016 Winter: January 3, 2017	180 credit hour program 49 credit hours apply from Pathway 131 credit hours remaining toward degree			
Entry Requirements	Term 1	Course Title	Credit Hours	Progression Requirements
Academic Requirements	ALS 150	Academic Reading and Writing	3	<ul style="list-style-type: none"> 2.25 GPA cumulative in the Pathway program No Satisfactory/Unsatisfactory (S/U) graded courses in OSU academic course work Grade of C- or better in English Composition (WR 121), Math (MTH 111 or higher) and Communication (COMM 111) Minimum of 36 credits earned during Pathway program
• High school diploma with a 2.5 GPA	ALS 151	Academic Listening and Speaking	3	
Language Requirements	MTH	Math Course - Variable Level*	4	
• TOEFL iBT 60 (PBT 500) or	HHS 231	Lifetime Fitness for Health	2	
• IELTS 5.5 or	ALS 181	Lifetime Fitness for Health Bridge	2	
• PTEA 44+ or	PAC	Physical Activity Class	1	
• Password overall level 6 or	Total 15			
• Completion of Academic English Level 4 with C (or Pass) or higher grades in all classes	Term 2	Course Title	Credit Hours	
	ALS 162	University Reading and Writing	3	
	CH 231	General Chemistry + Lab	5	
	MTH	Math Course - Variable Level*	4	
	COMM 111	Public Speaking	3	
	Total 15			
	Term 3	Course Title	Credit Hours	
	WR 121	English Composition	3	
	ALS 181	English Composition Bridge	2	
	MTH	Math Course - Variable Level*	4	
	CH 232	General Chemistry + Lab	5	
	ANTH 210	Cultural Diversity	3	
	ALS 181	Cultural Diversity ESL Bridge	2	
	Total 19			
	Term 4	(Recommended)		

science.oregonstate.edu

Women and Gender Studies				
3-Term Standard Pathway	Degree Program Components			Program Information
Fall: September 13, 2016 Winter: January 3, 2017 Spring: March 27, 2017	180 credit hour program 46 credit hours apply from Pathway 134 credit hours remaining toward degree			
Entry Requirements	Term 1	Course Title	Credit Hours	Progression Requirements
Academic Requirements	ALS 150	Academic Reading/Writing	3	<ul style="list-style-type: none"> 2.25 GPA cumulative in the Pathway program No Satisfactory/Unsatisfactory (S/U) graded courses in OSU academic course work Grade of C- or better in English Composition (WR 121), Math (MTH 111, MTH 105 or higher) and Communication (COMM 111) Minimum of 36 credits earned during Pathway program
• High school diploma with a 2.5 GPA	ALS 151	Academic Listening/Speaking	3	
Language Requirements	MTH	Math Course - Variable Level*	4	
• TOEFL iBT 60 (PBT 500) or	HHS 231	Lifetime Fitness for Health	2	
• IELTS 5.5 or	ALS 181	Lifetime Fitness for Health Bridge	2	
• PTEA 44+ or	PAC	Physical Activity Class	1	
• Password overall level 6 or	Total 15			
• Completion of Academic English Level 4 with C (or Pass) or higher grades in all classes	Term 2	Course Title	Credit Hours	
	ALS 162	Academic Reading/Writing	3	
	COMM 111	Public Speaking	3	
	WGSS 223	Women: Self and Society	3	
	ANTH 210	Comparative Cultures	3	
	ALS 181	Comparative Cultures Bridge	2	
	Total 14			
	Term 3	Course Title	Credit Hours	
	WR 121	English Composition	3	
	ALS 181	English Composition Bridge	2	
	WGSS 224	Women: Personal and Social Change	3	
	WGSS 280	Global Women	3	
	HST 201	History of the United States	4	
	ALS 181	History of the United States Bridge	2	
	Total 17			
	Term 4	(Optional)		

liberalarts.oregonstate.edu/slcs/wgss



“The Undergraduate Pathway program helped me adapt to the American college life and improve my English. It was a great transition from my home country to the United States.”

Igor Cheploutckii, Russia

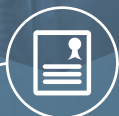

Fall 2014
Arrived at OSU for Undergraduate Engineering Pathway Program

Spring 2015
Completed Undergraduate Engineering Pathway

Fall 2015
Progressed to OSU in Civil Engineering



#37

Best Graduate Programs
for Public Health
(U.S. News & World Report 2015)



74%

of students in Graduate Pathway
programs progressed to OSU
Graduate degree programs
(Fall 2013)

Graduate



#76

Best Graduate Engineering
School in the US
(U.S. News & World Report 2016)

#26

Best Graduate Program for
Veterinary Medicine
(U.S. News & World Report 2015)

Graduate Direct Entry

OSU offers more than 80 graduate programs. Exceptional graduate students may be eligible for teaching and research assistantships which offer financial support for tuition and living expenses. As one of the nation's top research universities, OSU excels in securing research funding, which supports opportunities for graduate students.

1. Apply for Admission

Before starting your application make sure you meet our admissions requirements on page 33.

To apply, visit: oregonstate.force.com/GradAppLogin

Complete and submit the online application 6-12 months before your intended term start date.

- Pay the non-refundable \$85 application fee. Your application will not be processed until the fee is paid.

2. Meet Deadlines

Programs establish their own application deadlines, which are often substantially earlier than the general university deadlines. In absence of earlier program deadlines, follow the university deadlines. See program website for details.

Visit: gradschool.oregonstate.edu/programs

3. Submit Materials

- Materials can be uploaded into your online application during the application process or after the application has been submitted.
- To expedite processing, you can submit unofficial copies of transcripts. Official transcripts are only required if you obtain admission.
- Depending on your program, GRE/GMAT scores may or may not be required. When required, please have official GMAT scores sent from Pearson VUE Testing Service and GRE test scores sent from ETS.
- If your native language is not English, TOEFL/IELTS scores are required. For more information regarding English language waivers, please visit: gradschool.oregonstate.edu/admissions/international#english-language

Visit: gradschool.oregonstate.edu/admissions/process

4. Submit Immigration Documents*

- Financial statement that shows funding support based on the estimated cost of attendance for one calendar year (F-1 visa) or full length of degree (J-1 visa)
- A copy of your passport (and any dependents' passports)
- An OSU Certification of Finances form

*Not required for application review

5. Check Your Application Status

Visit: oregonstate.force.com/GradAppLogin

The graduate admission process involves review and approval by both the program and Graduate School. Processing times will vary. Please consult with your prospective program regarding their timeline for making admissions decisions.

6. Finalize Your Plans

If admitted to OSU, you will receive:

- Electronic notification of your admission
- An OSU letter of acceptance
- An acceptance packet explaining how to enroll at OSU
- An OSU I-20 (F-1 visa) or DS-2019 (J-1 visa)

Third-party Authorization

If a family member or educational counselor is completing the application on your behalf and you would like for OSU to communicate with them regarding your application, please specify this information in the release authorization section of the online application.

Academic and English Testing Score Codes for OSU

GRE: 4586	TOEFL: 4586
GMAT: PW4-DR-05	IELTS: DIRECT

OSU Degree Programs

Term	Start Dates	Graduate Application Deadline	Application Fee
Fall 2016	September 6, 2016	April 1, 2016	\$85
Winter 2017	January 5, 2017	July 1, 2016	\$85
Spring 2017	March 30, 2017	October 1, 2016	\$85
Summer 2017	June 23, 2017	January 1, 2017	\$85



Key Program Facts

Application Deadline Dates*

- Fall: April 1, 2016
- Winter: July 1, 2016
- Spring: October 1, 2016
- Summer: January 1, 2017

* Application deadlines may vary. Check specific program requirements at: gradschool.oregonstate.edu/programs

Start Dates

- Fall: September 6, 2016
- Winter: January 5, 2017
- Spring: March 30, 2017
- Summer: June 23, 2017

Direct Entry

Academic Entry Requirements

Regionally accredited degrees with:

- 3.0 GPA overall from four-year undergraduate or professional degree and all work completed thereafter **or**
- A 4-year undergraduate degree and a two-year (45 quarter credits) graduate degree with an overall GPA of 3.0 on most recent graduate degree **or**
- A completed bachelor's degree of at least three years duration in a country that is a signatory of the Bologna Declaration with an overall GPA of 3.0, plus all subsequent graded course work **or**
- A bachelor's degree of at least three years duration and a two-year (45 quarter credits) graduate degree with an overall GPA of 3.0 on most recent graduate degree

English Language Requirements

- TOEFL iBT 80 (PBT 550) (minimum 18 subscores) **or**
- IELTS 6.5
- Subscores under 18 will be conditionally admitted into the Transitional Admission Program
- Certain programs have higher minimum requirements

Meet Specific Program Requirements

Besides meeting general minimum admission requirements, you also must meet specific program requirements. For more information, visit: gradschool.oregonstate.edu/programs

Transitional Admission Program (TAP)

About the Program

- Combines degree and language courses
- Normally takes one to three terms to complete
- Only available for certain programs

Academic Entry Requirements

- Same as entry requirements above

English Language Requirements

- TOEFL iBT 61 (PBT 500) **or** IELTS 6.0

Possible Additional Application Materials

- Statement of objectives
- Three letters of professional reference
- GMAT **or** GRE
- Requirements vary by program

Graduate Pathway Programs

Our Graduate Pathway programs are the most supported and non-competitive route to a graduate program in an American Tier 1 research university. Students in the Graduate Pathway programs are assured admission to their graduate program upon successful completion of the progression requirements.

Understand the Pathway Program

The Graduate Pathway program is a pre-master's or pre-doctorate (only for Comparative Health Science Pathway) program that provides international students a direct path to various graduate degrees at the university. The program gives students the academic foundation, essential language skills and GMAT/GRE test preparation to successfully move on to a master's or doctoral degree.

Decide if the Program is Right for You

The Graduate Pathway program is designed for international students who:

- Desire to study a graduate degree in the US
- May need to improve English language skills and still earn credits toward their degree program
- Desire additional academic, language and cultural support in order to succeed during the first year at a US university
- May not be eligible for direct entry
- May need additional preparation for GMAT/GRE

Fully Integrated University Experience

The academic courses included in the Graduate Pathway programs are carefully chosen to ensure success in graduate-level studies. Students will be advised on which modules to follow during their academic orientation at the INTO OSU Center. For sample curricula, please refer to pages 37-43.

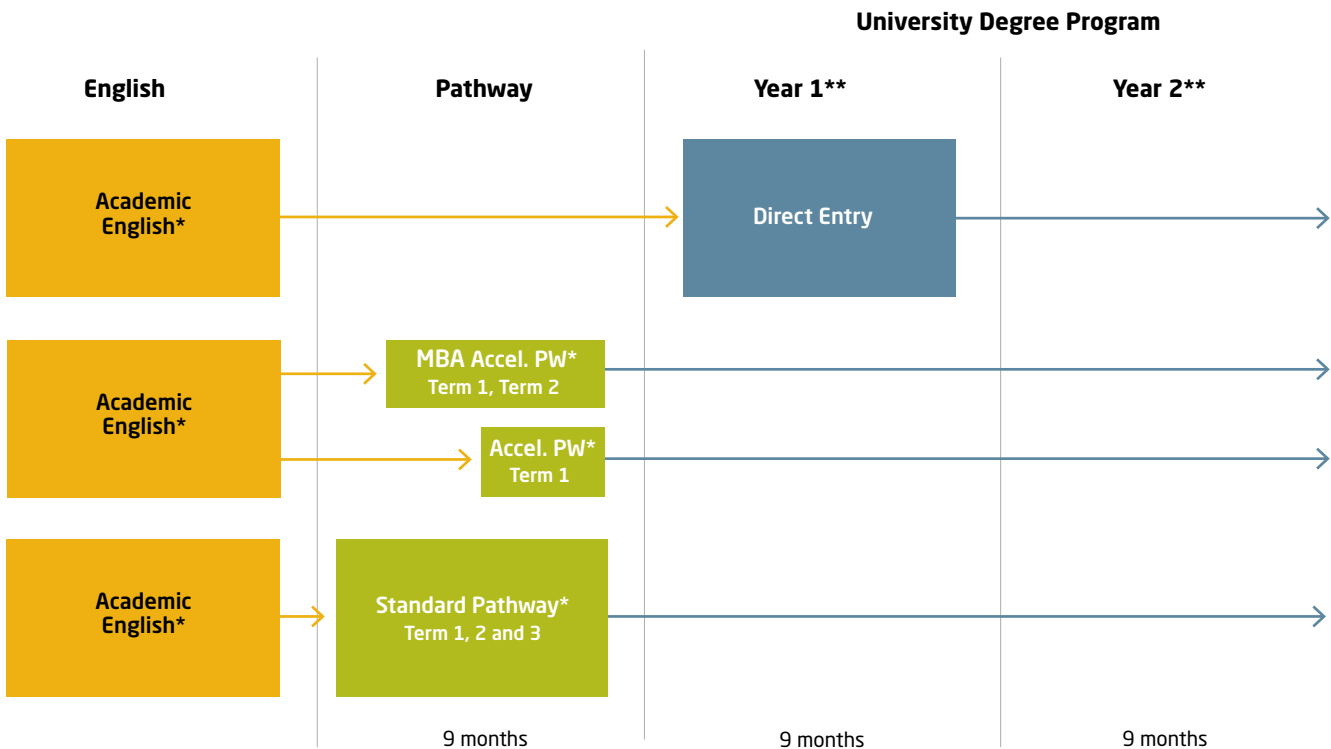

*If Academic English is needed, the length of the program will depend on language proficiency.

**The length of a graduate degree program depends on the academic area of study and the intended degree type and may take longer than two years to complete.

Overview of Entry Requirements

Pathway Programs	MBA		MEng			Comparative Health Sciences
	2-Term Accelerated	3-Term Standard	1-Term Accelerated (CS/ECE)	1-Term Accelerated (other MEng)	3-Term Standard	3-Term Standard
GPA	3.0 overall OR in final two years	2.75 overall AND in final year	3.0 overall OR in final two years	3.0 overall OR in final two years	2.75 overall AND in final year	3.2 overall AND in final year
Undergraduate Degree	Any major	Any major	Same major	Same major	Appropriate major*	Any major**
Standardized Test Scores	GMAT: 500 with minimum 20 V, 20 Q, 20 IR, 4 AW or GRE: total score of 304 with verbal and quantitative scores in at least the 30th percentile and an analytical writing score of 3.5	None	None	GRE: 301 with minimum 146 V, 3 AW	None	None
Work Experience	None	None	None	None	None	None
TOEFL iBT	80 (18 subscores)	70 (16 subscores)	80 (18 subscores)	80 (18 subscores)	70	70 (16 subscores)
IELTS	6.5 (5.5 subscores)	6.0 (5.5 subscores)	6.5 (5.5 subscores)	6.5 (5.5 subscores)	6.0	6.0 (5.0 subscores)
Password	-----	7	-----	-----	7	7
Academic English	Level 6 (B grades in all classes)	Level 5 (C grades in all classes)	Level 6 (B grades in all classes)	Level 6 (B grades in all classes)	Level 5 (C grades in all classes)	Level 5 (C grades in all classes)

*See pages 38-42 for specific major requirements.

**See page 43 for specific course work requirements.

Program Benefits

Pathway students receive the highest level of support during their transition abroad, making it an ideal choice for international students who are driven to achieve high academic goals. Other benefits include:

- Assured progression to an OSU graduate program (subject to successful completion of Pathway program and any additional requirements)
- Up to 40 hours of TOEFL test preparation and GMAT/GRE preparation
- Dedicated academic advisor and progression advisor to help facilitate transition to the university
- Pathway peer tutors available to provide additional academic support
- Noncompetitive entry

TOEFL, GMAT and GRE PREP

TOEFL, GMAT and GRE test preparation are built into the Graduate Pathway program curriculum. Students receive up to 40 hours of test preparation throughout the duration of the program. Our test preparation courses are taught by experienced OSU instructors and focus on skills-based language development and test-taking skills which include the use of practice tests and individual feedback on performance. We also provide self-study materials, available in our learning center.

The courses listed in the following tables are examples and are subject to change.

Graduate Pathway Programs

MBA

The Graduate Pathway for MBA is designed to provide a route and academic foundation for students wanting to pursue an MBA degree. The MBA Pathway and the MBA program combined will take two to three years to complete depending on course load and specialization options.

About the OSU MBA

The OSU MBA program challenges students with a rigorous and hands-on experience. You'll be expected to jump in, collaborate with your peers and put real-world projects into motion. The MBA program will also give you an understanding of how sustainable business meets economic, social and environmental needs without compromising the future of any of them. Sustainability is woven into our curriculum; when you leave, you'll be able to make a positive impact on the world. Please refer to business.oregonstate.edu/mba for more information about tracks and course of study.

Students who wish to earn an MBA at OSU must complete between 60-88 credit hours, which includes 15 credits of foundational course work and 45-73 credits of MBA core and specialization classes. Students in the INTO OSU Pathway program will enroll in the foundation courses and will have the opportunity to earn up to 15 credits toward their MBA degree while in the Pathway.

The Integrated Business Project

The OSU MBA supplements rigorous classroom instruction with practical, hands-on opportunities to learn by doing. This model gives you both the knowledge and the experience you need to lead in an increasingly complex and interconnected business environment. As an MBA student at OSU, you will work collaboratively in multi-cultural, interdisciplinary teams and will have the opportunity to complete an integrated business project in your chosen field of study.

MBA Tracks

The following specializations are available:

- Business Analytics
- Commercialization
- Global Operations
- Marketing
- Research Thesis
- Wealth Management

Math Placement for MBA Pathway Students

All Graduate Pathway MBA students are required to take the OSU Math Placement Test during orientation week. This test will place you in the most suitable math class. If you place at a lower level than MTH 245, you may require additional terms of study.

In order to prepare you for the MBA Graduate Pathway, you will have the opportunity to take the free, online OSU Math Placement Test in your home country. You can take the test in the six-month period before your Graduate MBA Pathway begins. After taking the test, you will have access to free, online math study materials for a period of six months. These materials are specifically designed to help you increase your math skills.

If you are completing the INTO OSU Academic English program prior to the MBA Pathway, you will have the opportunity to take the OSU Math Placement Test in the INTO OSU Center. If necessary, you will then be able to take a math course that will help you to reach the required math level by the time you start the MBA Pathway.

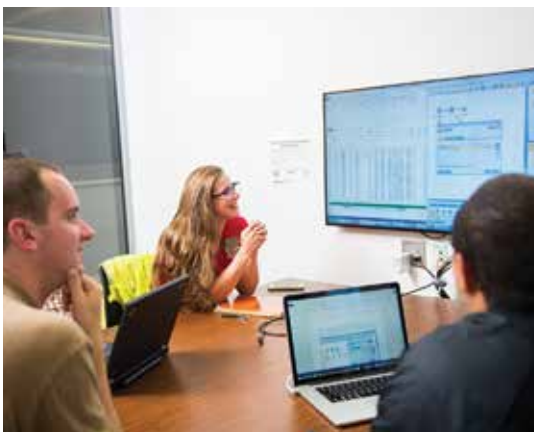

MBA			
2-Term Accelerated Pathway	Degree Program Components		Program Information
Spring: March 27, 2017	60-88 graduate credit hour program 15 foundational credits apply from the Pathway 45-73 credit hours remaining toward degree		
Entry Requirements	Term 1	Course Title	Credit Hours
Academic Requirements	ALS 162	Academic Reading/Writing (MBA)	3
<ul style="list-style-type: none"> Undergraduate degree in any major with 3.0 GPA overall or in final 2 years of study 	ALS 161	Academic Listening/Speaking (MBA)	3
Language Requirements	BA 512	Business Analysis and Communication	6
<ul style="list-style-type: none"> TOEFL iBT 80 (18 subscores) (PBT not accepted) or IELTS 6.5 (5.5 subscores) or Completion of Academic English Level 6 with B or higher grades in all classes 	BA 514	Essence of Business: Sustainable Operations	4
Other Requirements	Total		16
<ul style="list-style-type: none"> GMAT 500 with minimum 20th percentile in verbal, quantitative and integrated reasoning, and minimum analytical writing score of 4 or GRE total score of 304 with verbal and quantitative scores in at least the 30th percentile and an analytical writing score of 3.5 No work experience required 	Term 2	Course Title	Credit Hours
	BA 513	Essence of Business: Business Legal Environment	3
	BA 515	Essence of Business: Accounting and Finance	4
	BA 516	Essence of Business: Management and Marketing	4
	TOEFL Preparation		3
	Total		14
	Progression Requirements		
	Academic Requirements		
	<ul style="list-style-type: none"> 3.0 GPA cumulative for the last 90 quarter credits (60 semester credits) and 3.0 GPA cumulative and C- or higher grades in all Pathway courses (B- or higher grades required to progress to the nine-month MBA program) and 3.0 GPA cumulative in all BA classes in the Pathway 		
	Language Requirements		
	<ul style="list-style-type: none"> B or higher grades in ALS 161 and ALS 162 with minimum C in each skill. This is a co-requisite for BA 512. TOEFL iBT 91 (22 subscores) (PBT 575) or IELTS 7.0 		
	Additional Progression Requirements		
	<ul style="list-style-type: none"> Submission of a statement of objective Submission of a current résumé 3 Letters of Recommendation Compliance with OSU and College of Business Academic and Professional Behavior Standards (Please visit: business.oregonstate.edu/about/academic-professional-standards) 		
	These courses are generally delivered through the INTO OSU Center and are for Pathway students only.		
3-Term Standard Pathway	Degree Program Components		Program Information
Fall: September 13, 2016 Winter: January 3, 2017	60-88 graduate credit hour program 15 foundational credits apply from the Pathway 45-73 credit hours remaining toward degree		
Entry Requirements	Term 1	Course Title	Credit Hours
Academic Requirements	ALS 161	Academic Listening and Speaking (MBA)	3
<ul style="list-style-type: none"> Undergraduate degree in any major with a 2.75 GPA or equivalent overall and a minimum of 2.75 GPA in the final year of study 	ALS 162	Academic Reading and Writing (MBA)	3
Language Requirements	BA 211	Financial Accounting	4
<ul style="list-style-type: none"> TOEFL iBT 70 (16 subscores) (PBT 525) or IELTS 6.0 (5.5 subscores) or Password overall Level 7 or Completion of Academic English Level 5 with no grades below C and a Pass grade in all Pass/No Pass courses 	MTH 245	Mathematics for Management*	4
Other Requirements	ECON 201	Introduction to Microeconomics	4
<ul style="list-style-type: none"> No work experience required 	Total		18
	Term 2	Course Title	Credit Hours
	BA 213	Managerial Accounting	4
	BA 514	Sustainable Business Operations	4
	BA 512	Business Analysis and Communication	6
	GMAT Preparation		0
	Total		14
	BA 360	Introduction to Financial Management	4
	BA 390	Marketing	4
	BA 352	Managing Individual and Team Performance	4
	BA 233	Legal Environment of Business	2
	TOEFL Preparation		0
	Total		14
	Progression Requirements		
	Academic Requirements		
	<ul style="list-style-type: none"> 3.0 GPA cumulative for the last 90 quarter credits (60 semester credits) and 3.0 GPA cumulative and C- or higher grades in all Pathway courses (B- or higher grades required to progress to the nine-month MBA program) and 3.0 GPA cumulative in all BA classes in the Pathway 		
	Language Requirements		
	<ul style="list-style-type: none"> B or higher grades in ALS 161 and ALS 162 with minimum C in each skill. This is a pre-requisite for BA 512. TOEFL iBT 91 (22 subscores) (PBT 575) or IELTS 7.0 		
	Standardized Test Requirements		
	<ul style="list-style-type: none"> GMAT 500 with minimum 20th percentile in verbal, quantitative and integrated reasoning, and minimum analytical writing score of 4 or GRE total score of 304 with verbal and quantitative scores in at least the 30th percentile and an analytical writing score of 3.5 		
	Additional Progression Requirements		
	<ul style="list-style-type: none"> Submission of a statement of objective Submission of a current résumé 3 Letters of Recommendation Compliance with OSU and College of Business Academic and Professional Behavior Standards (Please visit: business.oregonstate.edu/about/academic-professional-standards) 		
	Notes		
	* See page 36 for details on Math Placement for MBA Pathway Students		
	These courses are generally delivered through the INTO OSU Center and are for Pathway students only.		

Graduate Pathway Programs

Master of Engineering

Accelerated Pathway for Graduate Engineering (MEng programs listed below)

1-Term Accelerated Pathway	Degree Program Components			Program Information
Fall: September 13, 2016 (ECE/CS*) Winter: January 3, 2017 (ECE/CS*) Spring: March 27, 2017 (All)	45 credit hour program 0 credit hours apply from Pathway 45 credit hours remaining toward degree			
Entry Requirements	Term 1	Course Title	Credit Hours	Progression Requirements
Academic Requirements	ALS 162	Academic Reading and Writing (MEng)	3	All MEng majors:
<ul style="list-style-type: none"> Undergraduate degree in same engineering discipline with 3.0 GPA overall or in final 2 years of study 	WR 327	Technical Writing	3	Academic Requirements
Language Requirements	ALS 181	INTO OSU Engineering Success	2	<ul style="list-style-type: none"> 3.0 GPA cumulative in all Pathway courses and C (or Pass) or higher grades in all Pathway courses
<ul style="list-style-type: none"> TOEFL iBT 80 (18 subscores) or IELTS 6.5 (5.5 subscores) or Completion of Academic English Level 6 with B (or Pass) or higher grades in all classes 	TBD	Course in major field to be determined	4	All MEng majors (except ECE/CS**):
Standardized Test Requirements	Total			Language Requirements
<ul style="list-style-type: none"> ECE/CS*: GRE not required All MEng majors (except ECE/CS*): GRE overall score of 301 with 145 in the verbal section and 3.0 in the analytical writing section 				<ul style="list-style-type: none"> B or higher grades in ALS 162 and WR 327 or TOEFL iBT 91 (18 subscores) (PBT 575) or IELTS 7.0
				Notes
				* ECE/CS - electrical and computer engineering/computer science
				** No additional language requirements for ECE/CS
				These courses are generally delivered through the INTO OSU Center and are for Pathway students only.

engineering.oregonstate.edu

Chemical Engineering

3-Term Standard Pathway	Degree Program Components			Program Information
Fall: September 13, 2016	45 credit hour program 11 credit hours apply from Pathway 34 credit hours remaining toward degree			
Entry Requirements	Term 1	Course Title	Credit Hours	Progression Requirements
Academic Requirements	ALS 161	Academic Listening and Speaking (MEng)	3	Academic Requirements
<ul style="list-style-type: none"> Undergraduate degree in chemical engineering with 2.75 GPA overall and in final year of study (other engineering degrees may require additional time and course work) 	ALS 162	Academic Reading and Writing (MEng)	3	<ul style="list-style-type: none"> 3.0 GPA cumulative for the last 90 quarter credits (60 semester credits) and 3.0 GPA cumulative in all Pathway courses and C (or Pass) or higher grades in all Pathway courses
Language Requirements	CHE 331	Transport Phenomena I	3	Language Requirements
<ul style="list-style-type: none"> TOEFL iBT 70 (PBT 525) or IELTS 6.0 or Password overall Level 7 or Completion of Academic English Level 5 with C (or Pass) or higher grades in all classes 	CHE 443	Chemical Reaction Engineering	4	<ul style="list-style-type: none"> B or higher grades in all English language courses or TOEFL iBT 91 (18 subscores) (PBT 575) or IELTS 7.0
	Total			Standardized Test Requirements
				<ul style="list-style-type: none"> GRE overall score of 301 with 146 in the verbal section and 3.0 in the analytical writing section
				These courses are generally delivered through the INTO OSU Center and are for Pathway students only.
	Term 2	Course Title	Credit Hours	
	COMM 111	Public Speaking	3	
	WR 121	English Composition	4	
	ALS 181	English Composition Bridge	2	
	CHE 332	Transport Phenomena II	3	
	CHE 550	Conventional and Alternative Energy Systems	3	
	ALS 181	INTO OSU Engineering Success	2	
	Total			
	Term 3	Course Title	Credit Hours	
	WR 327	Technical Writing	3	
	CHE 333	Transport Phenomena III	3	
	CHE 517	Instrumentation in Chemical, Biological and Environmental Engineering	4	
	CHE 545	Polymer Engineering and Science	4	
	Total			

cee.oregonstate.edu/che-graduate-program

Civil Engineering			
3-Term Standard Pathway	Degree Program Components		Program Information
Fall: September 13, 2016	45 credit hour program 0 credit hours apply from Pathway 45 credit hours remaining toward degree		
Entry Requirements	Term 1	Course Title	Credit Hours
Academic Requirements	ALS 161	Academic Listening and Speaking (MEng)	3
<ul style="list-style-type: none"> Undergraduate degree in a relevant engineering discipline with 2.75 GPA overall and in final year of study 	ALS 162	Academic Reading and Writing (MEng)	3
Language Requirements	ENGR 350	Sustainable Engineering	4
<ul style="list-style-type: none"> TOEFL iBT 70 (PBT 525) or IELTS 6.0 or Password overall Level 7 or Completion of Academic English Level 5 with C (or Pass) or higher grades in all classes 	ENGR 321	Materials Science	4
		GRE Prep	0
		Total	14
	Term 2	Course Title	Credit Hours
	COMM 111	Public Speaking	3
	WR 121	English Composition	3
	ALS 181	English Composition Bridge	2
	CE 372	Geotechnical Engineering	4
	CE 392	Intro to Highway Engineering	4
	ALS 181	INTO OSU Engineering Success	2
		Total	18
	Term 3	Course Title	Credit Hours
	WR 327	Technical Writing	3
	ST 314	Introduction to Statistics for Engineers	3
	CE 424	Contracts and Specifications	4
	ENGR 390	Engineering Economy	3
		Total	13

cce.oregonstate.edu/graduate-academics

Computer Science			
3-Term Standard Pathway	Degree Program Components		Program Information
Fall: September 13, 2016	45 credit hour program 8 credit hours apply from Pathway 37 credit hours remaining toward degree		
Entry Requirements	Term 1	Course Title	Credit Hours
Academic Requirements	ALS 161	Academic Listening and Speaking (MEng)	3
<ul style="list-style-type: none"> Undergraduate degree in a relevant engineering discipline with 2.75 GPA overall and in final year of study 	ALS 162	Academic Reading and Writing (MEng)	3
Language Requirements	CS 261	Data Structures	4
<ul style="list-style-type: none"> TOEFL iBT 70 (PBT 525) or IELTS 6.0 or Password overall Level 7 or Completion of Academic English Level 5 with C (or Pass) or higher grades in all classes 	CS 321	Theory of Computation	3
		Total	13
	Term 2	Course Title	Credit Hours
	COMM 111	Public Speaking	3
	WR 121	English Composition	3
	ALS 181	English Composition Bridge	2
	CS 344	Operating Systems I	3
	CS 325	Algorithms and Data Structures	4
	ALS 181	INTO OSU Engineering Success	2
		Total	17
	Term 3	Course Title	Credit Hours
	WR 327	Technical Writing	3
	CS 544	Operating Systems II	4
	CS 572	Computer Architecture	4
	CS 381	Programming Language Fundamentals	4
		Total	15

eecs.oregonstate.edu/academics/graduate-programs/cs

Graduate Pathway Programs

Master of Engineering

Construction and Engineering Management*			
3-Term Standard Pathway	Degree Program Components		Program Information
Fall: September 13, 2016	45 credit hour program 0 credit hours apply from Pathway 45 credit hours remaining toward degree		
Entry Requirements	Term 1	Course Title	Credit Hours
Academic Requirements	ALS 161	Academic Listening and Speaking (MEng)	3
<ul style="list-style-type: none"> Undergraduate degree in a relevant engineering discipline with 2.75 GPA overall and in final year of study 	ALS 162	Academic Reading and Writing (MEng)	3
Language Requirements	ENGR 350	Sustainable Engineering	4
<ul style="list-style-type: none"> TOEFL iBT 70 (PBT 525) or IELTS 6.0 or Password overall Level 7 or Completion of Academic English Level 5 with C (or Pass) or higher grades in all classes 	ENGR 321	Materials Science	4
		GRE Prep	0
		Total	14
	Term 2	Course Title	Credit Hours
	COMM 111	Public Speaking	3
	WR 121	English Composition	3
	ALS 181	English Composition ESL Bridge	2
	CE 372	Geotechnical Engineering	4
	CEM 311	Hydraulics	4
	ALS 181	INTO OSU Engineering Success	2
		Total	18
	Term 3	Course Title	Credit Hours
	WR 327	Technical Writing	3
	ST 314	Introduction to Statistics for Engineers	4
	CEM 341	Construction Estimating I	4
	ENGR 390	Engineering Economy	3
		Total	14
	Progression Requirements		
	Academic Requirements		<ul style="list-style-type: none"> 3.0 GPA cumulative for the last 90 quarter credits (60 semester credits) and 3.0 GPA cumulative in all Pathway courses and C (or Pass) or higher grades in all Pathway courses
	Language Requirements		<ul style="list-style-type: none"> B or higher grades in all English language courses or TOEFL iBT 91 (18 subscores) (PBT 575) or IELTS 7.0
	Standardized Test Requirements		<ul style="list-style-type: none"> GRE overall score of 301 with 146 in the verbal section and 3.0 in the analytical writing section
	Notes		<ul style="list-style-type: none"> * Students who complete the Construction Engineering Management concentration receive specialized training in construction and management and will be awarded a MEng degree in Civil Engineering.
	These courses are generally delivered through the INTO OSU Center and are for Pathway students only.		

cce.oregonstate.edu/content/construction-civil-engineering

Electrical and Computer Engineering			
3-Term Standard Pathway	Degree Program Components		Program Information
Fall: September 13, 2016	45 credit hour program 4 credit hours apply from Pathway 41 credit hours remaining toward degree		
Entry Requirements	Term 1	Course Title	Credit Hours
Academic Requirements	ALS 161	Academic Listening and Speaking (MEng)	3
<ul style="list-style-type: none"> Undergraduate degree in a relevant engineering discipline with 2.75 GPA overall and in final year of study 	ALS 162	Academic Reading and Writing (MEng)	3
Language Requirements	ECE 390	Electrical and Magnetic Fields	4
<ul style="list-style-type: none"> TOEFL iBT 70 (PBT 525) or IELTS 6.0 or Password overall Level 7 or Completion of Academic English Level 5 with C (or Pass) or higher grades in all classes 	ECE 351	Systems and Signals I	4
		Total	14
	Term 2	Course Title	Credit Hours
	COMM 111	Public Speaking	3
	WR 121	English Composition	3
	ALS 181	English Composition Bridge	2
	ECE 322	Electronics I	4
	ECE 352	Systems and Signals II	4
	ALS 181	INTO OSU Engineering Success	2
		Total	18
	Term 3	Course Title	Credit Hours
	WR 327	Technical Writing	3
	ECE 323	Electronics II	4
	ECE 353	Probability and Random Signals	4
	ECE 572	Computer Architecture	4
		Total	15
	Progression Requirements		
	Academic Requirements		<ul style="list-style-type: none"> 3.0 GPA cumulative for the last 90 quarter credits (60 semester credits) and 3.0 GPA cumulative in all Pathway courses and C (or Pass) or higher grades in all Pathway courses
	Language Requirements		<ul style="list-style-type: none"> B or higher grades in all English language courses or TOEFL iBT 80 (18 subscores) (PBT 550) or IELTS 6.5
	Standardized Test Requirements		<ul style="list-style-type: none"> GRE not required
	These courses are generally delivered through the INTO OSU Center and are for Pathway students only.		

eecs.oregonstate.edu/academics/graduate-programs/ece

Environmental Engineering			
3-Term Standard Pathway	Degree Program Components		Program Information
Fall: September 13, 2016	45 credit hour program 0 credit hours apply from Pathway 45 credit hours remaining toward degree		
Entry Requirements	Term 1	Course Title	Credit Hours
Academic Requirements	ALS 161	Academic Listening and Speaking (MEng)	3
<ul style="list-style-type: none"> Undergraduate degree in environmental engineering with 2.75 GPA overall and in final year of study (other engineering degrees may require additional time and course work) 	ALS 162	Academic Reading and Writing (MEng)	3
Language Requirements	CHE 331	Transport Phenomena I	3
<ul style="list-style-type: none"> TOEFL iBT 70 (PBT 525) or IELTS 6.0 or Password overall Level 7 or Completion of Academic English Level 5 with C (or Pass) or higher grades in all classes 	ENVE 421	Water and Wastewater Characterization	4
		GRE Prep	0
		Total	13
	Term 2	Course Title	Credit Hours
	COMM 111	Public Speaking	3
	WR 121	English Composition	4
	ALS 181	English Composition Bridge	2
	CHE 332	Transport Phenomena II	3
	ENVE 422	Environmental Engineering Design	4
	ALS 181	INTO OSU Engineering Success	2
		Total	18
	Term 3	Course Title	Credit Hours
	WR 327	Technical Writing	3
	ST 314	Introduction to Statistics for Engineers	3
	CHE 333	Transport Phenomena III	3
	CHE 334	Transport Phenomena Lab	2
	ENVE 425	Air Pollution Control	3
		Total	14

cbee.oregonstate.edu/node/93

Industrial Engineering			
3-Term Standard Pathway	Degree Program Components		Program Information
Fall: September 13, 2016	45 credit hour program 12 credit hours apply from Pathway 33 credit hours remaining toward degree		
Entry Requirements	Term 1	Course Title	Credit Hours
Academic Requirements	ALS 161	Academic Listening and Speaking (MEng)	3
<ul style="list-style-type: none"> Undergraduate degree in a relevant engineering discipline with 2.75 GPA overall and in final year of study 	ALS 162	Academic Reading and Writing (MEng)	3
Language Requirements	IE 512	Information Systems Engineering	4
<ul style="list-style-type: none"> TOEFL iBT 70 (PBT 525) or IELTS 6.0 or Password overall Level 7 or Completion of Academic English Level 5 with C (or Pass) or higher grades in all classes 	ST 314	Introduction to Statistics for Engineers	3
		GRE Prep	0
		Total	13
	Term 2	Course Title	Credit Hours
	COMM 111	Public Speaking	3
	WR 121	English Composition	3
	ALS 181	English Composition Bridge	2
	ST 511	Methods of Data Analysis	4
	IE 515	Simulation and Decision Support Systems	4
	ALS 181	INTO OSU Engineering Success	2
		Total	18
	Term 3	Course Title	Credit Hours
	WR 327	Technical Writing	3
	CS 161	Introduction to Computer Science I	4
	MTH 341	Linear Algebra I	3
	ENGR 390	Engineering Economy	3
		Total	13

mime.oregonstate.edu/academics/grad/ie

Graduate Pathway Programs

Engineering (continued)

Mechanical Engineering			
3-Term Standard Pathway	Degree Program Components		Program Information
Fall: September 13, 2016	45 credit hour program 4 credit hours apply from Pathway 41 credit hours remaining toward degree		
Entry Requirements	Term 1	Course Title	Credit Hours
Academic Requirements	ALS 161	Academic Listening and Speaking (MEng)	3
<ul style="list-style-type: none"> Undergraduate degree in a relevant engineering discipline with 2.75 GPA overall and in final year of study 	ALS 162	Academic Reading and Writing (MEng)	3
Language Requirements	ME 316	Mechanics of Materials	3
<ul style="list-style-type: none"> TOEFL iBT 70 (PBT 525) or IELTS 6.0 or Password overall Level 7 or Completion of Academic English Level 5 with C (or Pass) or higher grades in all classes 	ENGR 321	Materials Science	4
		GRE Prep	0
		Total	13
	Term 2	Course Title	Credit Hours
	COMM 111	Public Speaking	3
	WR 121	English Composition	3
	ALS 181	English Composition Bridge	2
	ME 311	Thermal Fluid Sciences	4
	ST 511	Methods of Data Analysis	4
	ALS 181	INTO OSU Engineering Success	2
		Total	18
	Term 3	Course Title	Credit Hours
	WR 327	Technical Writing	3
	ENGR 390	Engineering Economy	3
	ST 314	Intro to Statistics for Engineers	3
	ENGR 212	Dynamics	3
		Total	12

mime.oregonstate.edu/academics/grad/me

Mechanical Engineering with Materials Science Emphasis			
3-Term Standard Pathway	Degree Program Components		Program Information
Fall: September 13, 2016	45 credit hour program 11 credit hours apply from Pathway 34 credit hours remaining toward degree		
Entry Requirements	Term 1	Course Title	Credit Hours
Academic Requirements	ALS 161	Academic Listening and Speaking (MEng)	3
<ul style="list-style-type: none"> Undergraduate degree in a relevant engineering discipline with 2.75 GPA overall and in final year of study 	ALS 162	Academic Reading and Writing (MEng)	3
Language Requirements	ME 316	Mechanics of Materials	3
<ul style="list-style-type: none"> TOEFL iBT 70 (PBT 525) or IELTS 6.0 or Password overall Level 7 or Completion of Academic English Level 5 with C (or Pass) or higher grades in all classes 	ENGR 321	Introduction to Materials Science	4
		GRE Prep	0
		Total	13
	Term 2	Course Title	Credit Hours
	COMM 111	Public Speaking	3
	WR 121	English Composition	3
	ALS 181	English Composition Bridge	2
	ENGR 112	Intro to Engineering Computing	3
	ME 581	Thermodynamics of Materials	4
	ALS 181	INTO OSU Engineering Success	2
		Total	17
	Term 3	Course Title	Credit Hours
	WR327	Technical Writing	3
	ME 582	Rate Processes in Materials	4
	ME 524	Finite Element Modeling of Mechanical Engineering Systems	3
	ST 314	Intro to Statistics for Engineers	3
		Total	13

mime.oregonstate.edu/academics/grad/me

Graduate Pathway Programs

Comparative Health Sciences

Comparative Health Sciences			
3-Term Standard Pathway	Degree Program Components		Program Information
Fall: September 13, 2016	45 credit hour program (M.S.); 108 credit hour program (Ph.D.) 0 credit hours apply from Pathway 45 credit hours remaining toward degree (M.S.); 108 credit hours remaining toward degree (Ph.D.)		
Entry Requirements	Term 1	Course Title	Credit Hours
Academic Requirements	ALS 162	Academic Reading and Writing	3
<ul style="list-style-type: none"> Undergraduate degree with 3.2 GPA overall and in final year of study Any undergraduate degree will be considered. Students should have a strong university-level biology background. 	ALS 161	Academic Listening and Speaking	3
Language Requirements	BI 314	Cell and Molecular Biology	4
<ul style="list-style-type: none"> TOEFL iBT 70 (16 subscores) (PBT 525) or IELTS 6.0 (5.0 subscores) or Password overall Level 7 or Completion of Academic English Level 5 with C (or Pass) or higher grades in all classes 	BB 331	Introduction to Molecular Biology	3
		Topics in Comparative Medicine	2
		Total	15
	Term 2	Course Title	Credit Hours
	COMM 111	Public Speaking	3
	WR 327	Technical Writing	3
	ST 351	Introduction to Statistical Methods	4
	TBD	Course in major field to be determined	4
	GRE prep		0
		Total	14
	Term 3	Course Title	Credit Hours
	WR 362	Science Writing	3
	BI 213	Principles of Biology	4
	NUTR 420	Human Nutrition	3
	NUTR 421	Applications in Human Nutrition	1
		Introduction to Research Topics	3
		Total	14
	Progression Requirements		
	Academic Requirements		
	<ul style="list-style-type: none"> 3.5 GPA cumulative in all Pathway courses and Comparative Health Sciences courses and C (or Pass) or higher grades in all Pathway courses 		
	Language Requirements		
	<ul style="list-style-type: none"> B or higher grades in all English language courses or TOEFL iBT 91 (18 subscores) (PBT not accepted) or IELTS 7.0 		
	Standardized Test Requirements		
	<ul style="list-style-type: none"> GRE overall score of 301 with 146 in the verbal section and 3.0 in the analytical writing section 		
	These courses are generally delivered through the INTO OSU Center and are for Pathway students only.		

vetmed.oregonstate.edu/graduate-programs



“The Graduate Pathway program helped me adapt to a new environment. I’m now familiar with the professors I will meet in graduate school and it gave me the opportunity to prepare for the courses I will take as a graduate student.”

Mao Yating, China

Graduate Pathway, Chemical Engineering



More than 90 highly trained and experienced teaching staff



Access to all university facilities

English Language Program



1:18

Average teacher-to-student
ratio in the classroom

Academic English and
General English programs
are accredited by CEA

Academic English

Program Description

The Academic English program at INTO Oregon State University prepares international students for university study in the US. This academically rigorous program provides international students with high-quality English language instruction and the academic skills to succeed at OSU through development of:

- Listening
- Speaking
- Reading
- Writing
- Standardized test preparation
- Academic study skills

Program Highlights

- Intensive English to prepare for university study
- Academic advising throughout the program
- Small classes of 18-20 students
- Highly-trained and experienced instructors
- Participation in the conversant program

Program Outcomes

After finishing this intensive program, successful students will be able to:

- Interact comfortably in the US classroom with professors and fellow students
- Understand US values in an academic setting
- Present their spoken and written ideas accurately and effectively in English
- Write research papers with proper use of citations and references
- Use the internet and OSU library databases to conduct academic research
- Read, understand and critically evaluate academic texts
- Understand and use vocabulary common to academic disciplines
- Take useful and accurate notes in academic lectures and presentations
- Develop and deliver oral presentations



Academic English Placement Equivalencies

The table below gives a realistic estimation of the Academic English level that students enter with on arrival. It is based on an analysis of placement data. All AE students take a test on arrival that places them in the most suitable AE level. AE is a great way to be fully prepared for a Pathway program.

Estimated AE Level	TOEFL iBT	IELTS	PTE	Password
2	32-44	3.5-4.0	38 or less	2-3
3	45-59	4.5-5.0	39-43	4-5
4	60	5.5	44	6
5	70	6.0	48	7
6	80	6.5	53	8

Some students place into a higher level than estimated here. Any student who places lower than the estimated level is guaranteed to be placed no more than one level lower.

Key Program Facts

Start Dates*

- Fall: September 13, 2016
- Winter: January 3, 2017
- Spring: March 28, 2017
- Summer: June 21, 2017

* Students must arrive at least one day prior to the program start date.

Program Duration

- Each term is 10-11 weeks in length
- 4 terms per year

Academic Entry Requirement

- High school diploma

English Language Entry Requirement

- None; students will be assessed and placed upon arrival (see table below left)

Age Requirement

- 16 years old and above

Program Structure

- 7 levels of instruction
- Foundation Preparation through Level 2 combines both General English and Academic English students
- 18 hours per week of course work covering the core skills of reading, writing, listening and speaking (students in Levels 1 and 2 take 27 hours of lessons per week)
- Choice of electives at higher levels

English Language Progression Requirements

Undergraduate Pathway Programs (Standard)

- Completion of Academic English Level 4 and all Academic English courses with minimum C/Pass grades

Undergraduate Pathway Programs (Accelerated 1 term)

- Completion of Academic English Level 6 with C (or Pass) or higher in all classes

Undergraduate Pathway Programs (Accelerated 2 term)

- Completion of Academic English Level 5 with C (or Pass) or higher in all classes

Graduate Pathway Programs (Standard)

- Completion of Academic English Level 5 and all Academic English courses with minimum C/Pass grades

Graduate Pathway Programs (Accelerated 1/2 term)

- Completion of Academic English Level 6 with B (or Pass) or higher in all classes

Direct Undergraduate Admission

- Completion of Academic English Level 6 and all Academic English courses with minimum C/Pass grades

Direct Graduate Admission

- Completion of Academic English Level 6 and all Academic English courses with minimum B/Pass grades
- Some departments require standardized test scores. See page 35 for more details.

General English

Program Description

The General English program consists of five-week sessions designed for students of all levels of English who want to develop communication skills in a variety of social and professional situations while learning about American culture.

Program Highlights

- English instruction for personal or employment motives
- Curriculum tied to the Common European Framework of Reference
- Academic advising throughout the program
- Small classes of 18-20 students
- Use of a fully-equipped learning center with state-of-the-art technology
- Students up to Level 3 have in-class conversation practice with OSU students
- Varied electives such as English through Photography and English through Volunteering
- Many opportunities for learning outside the classroom, including field trips both on campus and in the community

Program Outcomes

The General English program allows students to tailor their program to suit their personal, professional and academic goals. General English students will be able to:

- Improve general language proficiency in listening, speaking, vocabulary, reading and writing
- Expand career prospects by improving English language proficiency
- Develop conversation skills for real-world situations such as greeting, initiating a conversation, turn-taking, interrupting, asking for information
- Read and understand schedules, signs, ads and other authentic materials
- Understand basic cultural values and behaviors of Americans in order to interact appropriately
- Have the opportunity to interact with native speakers
- Progress to Academic English for further study at OSU

College Year Abroad

College Year Abroad is a long-term General English program for students who want to fully experience an American university. As with regular General English students, College Year Abroad students have access to all the same resources and amenities as all other university students including:

- Access to Dixon Recreation Center (on-campus gym facility)
- Access to OSU's Valley Library
- Participation in OSU clubs and activities
- Free tickets to OSU athletic events
- Use of a fully-equipped Learning Center with state-of-the-art technology
- Access to the student health center and other student welfare resources on campus

In addition, many College Year Abroad and General English students who choose shared on-campus housing are placed with American roommates, further enhancing their study abroad experience in America. With American roommates, and conversation groups/social programs organized by INTO OSU, students are more likely to have a successful experience integrating to the campus community and American lifestyle.

Key Program Facts

Start Dates: General English*

Fall

- September 19, 2016
- October 31, 2016

Winter

- January 5, 2017
- February 13, 2017

Spring

- March 30, 2017
- May 8, 2017

Summer

- June 22, 2017
- July 31, 2017

* Students must arrive at least one day prior to the program start date.

Start and End Dates: College Year Abroad

25-Week Programs

- September 19, 2016 - April 28, 2017
- October 31, 2016 - June 9, 2017
- January 5, 2017 - July 21, 2017
- February 13, 2017 - September 1, 2017
- March 30, 2017 - October 28, 2017
- May 8, 2017 - December 8, 2017
- June 22, 2017 - February 9, 2018
- July 31, 2017 - March 23, 2018

35-Week Programs

- September 19, 2016 - July 21, 2017
- October 31, 2016 - September 1, 2017
- January 5, 2017 - October 27, 2017
- February 13, 2017 - December 8, 2017
- March 30, 2017 - February 9, 2018
- May 8, 2017 - March 23, 2018
- June 22, 2017 - May 4, 2018
- July 31, 2017 - June 15, 2018

Program Duration: General English

- Each session is 5 weeks in length
- 8 sessions per year

Program Duration: College Year Abroad

- 25 or 35 weeks

English Language Entry Requirement

- None, students will be assessed and placed upon arrival.

Age Requirement

- 16 years old and above

Program Structure

- 6 levels of instruction
- Foundation Preparation through level 2 combines both General English and Academic English students
- All levels: One Listening/Speaking/ Vocabulary course
- All levels: One Reading/Writing course
- Choice of one or two elective courses depending on your level
- 21 (Standard) or 27 (Intensive) hours per week

Study Abroad with English

Our Study Abroad with English program allows non-degree-seeking international students to study at OSU while earning college credits.

Program Description

Study Abroad with English combines Academic English language study with the chance to experience undergraduate courses at OSU. This unique program allows students to earn college credits in their field of interest without having to enroll in a long-term degree program. The length of the program will vary depending on a student's needs. The program can be customized for different levels of English and for specific academic interests.

With prior approval from a student's home university, the academic courses studied at OSU can be used to gain credits toward an undergraduate degree in his or her home country. Earned credits may also be applied to a degree program with admission to OSU.

Part 1

Part 1 includes full-time intensive study in the Academic English program to the level required for taking credit courses at OSU. This intensive program starts at four different entry points during the year, in fall, winter, spring and summer.

Part 2

Students are able to select from OSU undergraduate courses and study alongside domestic and international students while continuing to take English language classes as well.

Part 3

Students will be part of the Visiting International Student Program. Please refer to page 49 for more information and for start dates.

Key Program Facts

Start Dates: Part 1

Fall: September 13, 2016

Winter: January 3, 2017

Spring: March 28, 2017

Summer: June 21, 2017

* Students must arrive at least one day prior to the program start date.

Start Dates: Part 2

Fall: September 13, 2016

Winter: January 3, 2017

Spring: March 28, 2017

Summer: June 21, 2017

* Students must arrive at least one day prior to the program start date.

Program Duration

- Minimum of 1 term or approximately 3 months

Academic Requirement

- High school diploma with 3.0 GPA or completion of at least one year of study at a university overseas with a minimum GPA of 2.5

Age Requirement

- 16 years old and above

English Language Requirements: Part 2

- TOEFL iBT 60 (PBT 500) **or**
- IELTS 5.5 **or**
- Password overall Level 6 **or**
- PTEA 44+ **or**
- Completion of Level 4 with minimum C/Pass grades in Study Abroad with English Part 1 or Academic English



Visiting International Student Program

Our Visiting International Student Program is designed for international students looking to study Liberal Arts abroad for one or more terms at a US university.

Program Description

The Visiting International Student Program is designed for students who want one or more terms of study abroad experience at a top US university. The program provides students with a classic American university experience while taking a variety of credit-bearing classes. Students will have access to all the support services available at the university and INTO OSU, including exceptional one-on-one tutoring, social and cultural trips and more. Intensive English courses are available but are not a mandatory part of the program.

Course Selection

INTO OSU has partnered with the OSU College of Liberal Arts to make a wide range of courses available to VISIP students. A selection of available courses is listed below. Other courses may be available in the College of Liberal Arts by special arrangement. Departmental approval is required for enrollment in courses outside the College of Liberal Arts.

Transferring Courses

Courses taken are transferable in accordance with articulation policies of the student's home university. All courses taken as part of the Visiting International Student Program are credit-bearing (except intensive English courses, if selected). Students should coordinate with their home university to ensure courses taken through VISIP are transferable to their degree.

Key Program Facts

Start Dates

Fall: September 13, 2016

Winter: January 3, 2017

Spring: March 28, 2017

Summer: June 21, 2017

* Students must arrive at least one day prior to the program start date.

Program Duration

- Minimum of 1 term or approximately 3 months

Academic Requirement

- High school diploma with 3.0 GPA or completion of at least one year of study at a university overseas with a minimum GPA of 2.5

Age Requirement

- 16 years old and above

English Language Requirements

- TOEFL iBT 80 (minimum 16 subscores) (PBT 550) **or**
- IELTS 6.5 **or**
- Completion of AE Level 6

Sample Course Offerings

The following list of Visiting International Student Program courses is only a representative sample. Other courses may be available.

Course Number	Course Title	Credit Hours
FILM 125	Intro to Film Studies: 1945-Present	3
HST/PHL 210	Religion in the US	4
PSY 201	General Psychology	3
SOC 206	Social Problems and Issues	3
ART 101	Intro to Visual Arts	4
SOC 204	Introduction to Sociology	3
TA 147	Intro to the Theater	3





More than 300
student clubs

More than 30 cafés and
restaurants on campus

Student Life



Top 23

Most Spirited
College Campuses
(Huffington Post 2012)



97% of streets
in Corvallis have
bike lanes



▲ INTO OSU Learning Center

▼ Beth Ray Center for Academic Success



The Valley Library is open
24 hours a day during the week

Academic Success

International students at OSU are highly successful. There are many academic support resources at OSU which can be tailored to meet the needs of individual students.

Orientation

Orientation is your first step toward a successful academic career at OSU. Directly admitted students will receive information in advance about OSU Online Academic Advising and Registration, also called START. All other students will be tested according to their program of study and registered into classes during orientation. You will have the opportunity to take care of other steps, such as obtaining an OSU ID card, completing any remaining immunization requirements, becoming familiar with the campus and Corvallis, as well as learning about the requirements of your student visa. Orientation is required for all new students.

First Year Experience

The First Year Experience at OSU combines intensive academic advising and special courses to help full-time, first-year students succeed. FYE requires that students live on campus as data shows students who live on campus in residence halls typically earn higher grades than those who live off campus.

Tutors and One-on-one Support

You can make appointments or drop in for help with classes and assignments in a variety of subjects and locations. Specialized assistance is available for writing, reading, math, physics, chemistry, as well as an online writing lab. Assistance is available to learn effective study skills, time management and test-taking strategies. There are several locations where you can get support:

- Academic Success Center
- Writing Center
- Collaborative Learning Center
- Math Learning Center

Valley Library

The Valley Library is open 24 hours, Sunday through Friday. Saturday hours are 10 am to 10 pm. You can receive help with computer issues, use private and group study spaces and check out laptops and e-readers. There also are 100+ computers, printers and copiers. Make sure to see the 3D printers too.

Computers and Online Resources

Student Computing Facilities offer more than 100 Macs and PCs equipped with the latest software in an open lab setting. Scanners, laser printing, video editing and over 100 computer programs are provided.

Technology Support Services

Computer consultants are available by phone, email or online through the OSU help desk.

The First Year Experience combines on-campus housing, academic support and community involvement



▼ There are two medical clinics on OSU Main Campus.



▼ Centro Cultural César Chávez



7

Cultural centers representing the diversity of the campus population



University Student Services

All international students have full access to the resources, services and amenities offered at Oregon State University.

Health Services

There are two medical clinics on campus where students can see a doctor or nurse. Many, but not all, consultations will be covered by the international student health insurance plan. The services available on campus include: physicians, nurse practitioners, physician assistants, nutrition consultations, acupuncture, chiropractors, x-rays and more. OSU Health Services also support students' mental health and well-being through counseling, group conversations and presentations on topics such as stress management and healthy relationships. We have the following offices on campus:

- Student Health Services
- Tebeau Hall Drop-in Clinic (near the ILLC)
- Counseling and Psychological Services
- Disability Access Services
- Health Promotion
- Alcohol, Drug and Violence Prevention Center
- Clinical Services at Dixon Recreation Center

Insurance

The health insurance system in the US is very complicated, but OSU students have access to a quality insurance plan at a reasonable cost. The OSU International Student Health Plan will be automatically added to your student account after arrival unless proof of suitable alternative coverage is provided. Some sponsor insurance policies may be an acceptable alternative to the OSU policy. To learn more about the insurance plan, please visit: studenthealth.oregonstate.edu/internationalplan

While some services may be covered 100%, this is not true for all services; you should study the details of your health plan carefully. Keep in mind that you will often have to pay a partial cost of medical services yourself, even if you have an insurance policy.

Visa and Immigration Support

International Student Advising and Services provides advising on immigration and visa regulations, as well as general advising on academic or personal issues and university policies. They can also direct students to the appropriate university offices or resources in the community for support.

Public Safety

The Department of Public Safety and Oregon State Police provide a safe campus for OSU students, faculty, staff and visitors. State troopers and public safety officers patrol the campus 24 hours a day, seven days a week.

Religious and Spiritual Life

OSU is a place which welcomes diversity, including religious or cultural traditions. There are "quiet spaces" all over campus provided for students to practice their religion or enjoy quiet reflection outside of any particular faith. In addition to accommodations for dietary needs, you also will find foot washing stations, and some bathrooms that have been modified to allow for other cultural practices. If you have a question about how you will be able to practice your religion, please ask.

Diversity and Cultural Engagement

The seven cultural centers at OSU provide a comfortable space and valuable support to students from different cultural groups. They also offer a range of exciting programming for the wider campus community.

- Asian and Pacific Cultural Center
- Centro Cultural César Chávez
- Ettihad Cultural Center
- Lonnie B. Harris Black Cultural Center
- Native American Longhouse
- Pride Center
- Women's Center

Free Transportation
Access to public transportation and shuttle service throughout campus

▼ Come by the ILLC Welcome Desk to receive help from our staff.



▼ Annual INTO OSU trip to Crater Lake National Park



The INTO OSU Difference

INTO OSU provides students with a variety of comprehensive services to ensure a smooth transition to university life and American culture.

Personalized Service

At the International Living and Learning Center, simply stop by the Welcome Desk with any question you have. Our well-trained staff will ensure you receive the services you need or are directed to the right person.

Arrival and Housing

From the moment you arrive at the airport, INTO OSU will help you with the details. Enjoy our complimentary shuttle service from the Portland airport and dedicated housing staff to support your on-campus or graduate housing living experience.

Trips and Activities

INTO OSU provides trips and activities that help students feel at home in Corvallis and the surrounding areas. Whether shopping in Seattle, exploring the Oregon coast or celebrating American holidays together, students will have a guided, first-hand experience of life in America.

Language and Culture Advisors

Language and culture advisors are available to assist new and prospective students and parents who may not be able to communicate effectively in English. They also support students throughout their time at INTO OSU.

English Conversation

At INTO OSU, there are many opportunities for students to practice their spoken English. One-on-one and small group conversation partners are available for all types of students on a first-come, first-served basis.

Cultural Adjustment

The Student Services team provides a comprehensive orientation, workshops, advising and opportunities to connect with Americans. This will help you understand US cultural values and classroom expectations.

Student Advising

INTO OSU staff are available to meet with students one-on-one for advising on a range of issues, including classes, study plan, academic success, cultural adjustment, understanding center and university policies and more.

Academic Support

Academic support staff assist students every step of the way with placement, class registration, progress tracking, changes to study plan, term dates, extensions and more.

Pathway Program Services

Students in Pathway programs receive additional support from the Pathway Academic Success Advisors and the Progression Advisors, as well as learning resources through the learning center.

INTO OSU Learning Center

The INTO OSU Learning Center provides computers for student use, language learning software and a library of books, magazines, CDs and DVDs to ensure student success. TOEFL materials are available.

Pathway Peer Tutors

Pathway students have access to tutoring services through the INTO OSU Learning Center. Our Tutors are OSU students who can help with English skills, math, science, engineering and business.

Writing and Pronunciation

All INTO OSU students have access to tutors who are trained to help with writing and pronunciation. Both appointments and walk-in times are available.

▼ Reser Stadium



▼ Indoor Climbing Center



▼ Student Legacy Park



Free use of Dixon
Recreation Center and its
facilities for OSU students

Sports and Recreation

At Oregon State you will find NCAA Division 1, Pac-12 Conference sports and all the excitement that comes with them. Students here enjoy the use of world-class athletic facilities and value a healthy, active lifestyle.

NCAA Division 1 Athletics

OSU students love watching our sports teams compete. Going to a football game is a rite of passage for OSU students and a cultural experience that international students are sure to enjoy. You can look forward to becoming a part of Beaver Nation by being an active Beaver Fan. Tickets for all sporting events are free to students.

OSU athletic teams are proud of their talented international athletes. Our most famous international athletes include: Saori Haruguchi from Japan in swimming, Diego Velazquez from Colombia in golf, Leslie Mak from Canada in gymnastics and Danny Mwanga from the Democratic Republic of Congo in soccer. Athlete selection and scholarships are determined by the coaching staff and are highly competitive. INTO OSU students must progress to OSU before trying out. NCAA eligibility rules apply.

OSU's NCAA Men's Sports Teams:

baseball, basketball, football, golf, rowing, soccer and wrestling

OSU's NCAA Women's Sports Teams:

basketball, cross country, golf, gymnastics, rowing, soccer, softball, swimming, track and volleyball

Intramural Sports

Intramural sports are open to all students. Participation is informal and just for fun. There are more than 35 leagues at OSU offering opportunities to play and compete with others on campus, including badminton, table tennis, volleyball, basketball, soccer and more.

Club Sports

If you would like a little more competition, club sports are student-run organizations that participate in regional and national leagues and tournaments, and are open to everyone. The focus of club sports is to offer recreational, educational, competitive and diverse opportunities for students at a variety of skill levels.

Membership fees may be required. Club teams include judo, kendo, badminton, bowling, rugby, karate, table tennis and more.

Dixon Recreation Center

Dixon Recreation Center is a central feature of many OSU students' healthy lifestyles. Students come here to exercise, meet with friends, play sports, take a workout class or get a tasty smoothie. OSU students value their health and doing activities that keep them fit. Regular exercise helps you study, aids your memory and promotes better sleep.

All students have free use of Dixon Recreation Center with their OSU ID card. The Dixon Recreation Center is fully equipped with high-quality sports equipment. Dixon offers:

- Indoor climbing center
- Sand volleyball courts
- Pool, hot tub, sauna and sun deck
- Rental equipment for outdoor adventures
- Exercise equipment
- Basketball, volleyball, racquetball and tennis courts
- Indoor and outdoor running tracks
- Café serving healthy snacks and smoothies
- New outdoor track and turf fields in the center of campus

Pac-12

Conference Sports
NCAA Division I Athletics





▼ Student Experience Center



▼ OSU Mascot, Benny the Beaver



Being an OSU Student

Oregon State University offers a very friendly and welcoming community where students will find a variety of activities outside the classroom. Students are highly involved on campus; it is a great way for them to make new friends and gain hands-on experience.

International Students of Oregon State University

ISOSU and its 19 affiliate organizations promote cross-cultural interaction, along with support and involvement opportunities for international and multicultural students.

ISOSU Cultural Associations

- African Student Association
- Association of Latin American Students
- Cambodian Student Association
- Chinese Association of OSU
- Hmong Student Association
- Hong Kong Student Association
- Indian Student Association
- Indonesian Student Association
- Iranian Student Association
- Isang Bansang Pilipino
- Japanese Student Association
- Korean Student Association
- Laos Student Association
- Malaysian Student Association
- Omani Student Association
- Saudi Arabian Student Association
- Slavic Student Association
- Taiwanese Student Association
- Vietnamese Student Association

International Resource Center

The International Resource Center is a space where international students and culturally curious locals can gather to promote international understanding and to celebrate the diversity on campus. The IRC organizes various events throughout the year to encourage our international and domestic students to share their cultures with each other. Students can use this space to study or socialize.

INTO OSU Student Success Association

The IOSSA facilitates interaction between INTO OSU students and the domestic students of OSU to increase student engagement at the university level. They also support students' academic success and progression to the university through awareness of resources, support of department-sponsored student organizations and positive modeling.

Memorial Union

The Memorial Union is the heart of student life on campus. Here, students can find many different services including campus information, ATM machines, a convenience store, restaurants, bowling, billiards and more. Known on campus as the MU, it is a great place to relax, study and meet with people.

Life in Oregon

Oregon is famous around the world for its natural beauty and relaxed lifestyle. During breaks or long weekends, students enjoy traveling around different parts of the region. Portland, the largest city in Oregon, is located 90 minutes from Corvallis. Seattle is located only five hours north of Corvallis. The Pacific Northwest is a beautiful, exciting part of the world that international students love to explore. They often travel to nearby beaches or mountains looking for new adventures.

There are frequent concerts, lectures and performances on campus and in the community. International students often go out to eat together at local restaurants, or hang out with friends at their residence halls or apartments. There are also sidewalk cafés, rooftop restaurants, parks, bike paths and coffee shops.



Living on Campus

Living on campus is one of the best ways for international students to make American friends, adjust to life in the US and be part of the fun and vibrant community at Oregon State University.

On-campus Living

All first-year students at OSU live on campus, making it a welcoming, supportive and exciting place to be. Research has demonstrated that students who live on campus have higher GPAs and become more involved with campus activities and clubs. Students also enjoy the convenience and access to additional support services and staff. For more information about all residence halls, please visit: oregonstate.edu/uhds/halls

On-campus Policy

First-year students who enroll in an undergraduate degree-seeking program at Oregon State University within one year of high school graduation, regardless of class standing, must live on campus for the full academic year (fall, winter and spring terms). This includes all students with Undergraduate Pathway in their study plan. Spaces are guaranteed for first-year students.

Benefits of Living on Campus

First-year students who live in residence halls typically earn higher grades than those who live off campus. In fact, students who live on campus their first year also tend to graduate more quickly than those who don't.

There are also more academic support resources available to students who live in the residence halls. Each hall hosts a writing and math tutor every week, as well as a live-in Academic Learning Assistant, who provides academic coaching and organizes academic success-focused events, workshops and seminars during the year. Plus, students have easy access to ready-made study groups with their neighbors.

Amenities

- Fully furnished rooms with a bed, nightstand, desk, chair and wardrobe for each resident
- Communal kitchens, cooking and food storage facilities and dining area
- Study areas, lounges and recreation spaces with TVs, pool tables and other entertainment
- Free wireless internet throughout the building
- Free self-service laundry facilities
- Smoke-free
- Convenient location on campus
- Meal plan included, wide selection of dining options on campus

Added Benefits and Special Services

- Live-in residential staff members who provide housing and academic support to students
- Continued housing during academic year breaks
- In-hall academic assistance for math, writing and academic success

Safety and Accessibility

- All residence halls are secured with locked doors and resident-only access
- Elevators to all floors
- Wheelchair-accessible rooms situated near elevators and entrances

On-campus Dining

Finding something to eat on campus is easy. There are more than 30 restaurants and cafés, including several that feature international cuisines. Your dining plan will be automatically loaded on your student ID card to make purchases. Learn more about eating on campus, please visit: oregonstate.edu/uhds/dining

Special Diets

Menus in the dining centers are designed to help you make choices that meet your dietary or cultural needs. If you have any questions or concerns about what to eat on campus, you can meet with OSU's registered dietician to learn more about your options. The dining centers on campus are designed to serve the following special diets:

- Food allergies
- Halal
- Vegan and vegetarian
- Gluten-free
- Healthy choices

Housing Floor Plans

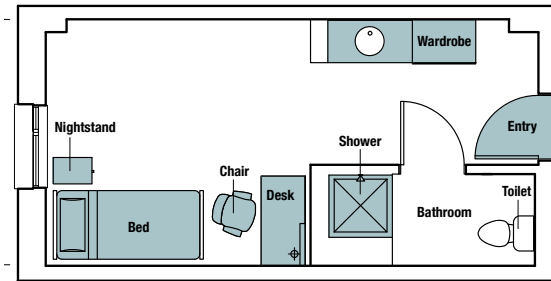

▲ On-Campus: Single room with private bathroom*

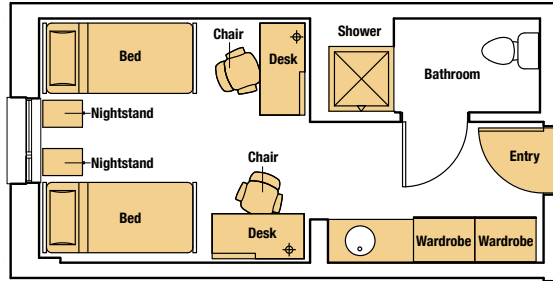

▲ On-Campus: Double room with private bathroom*

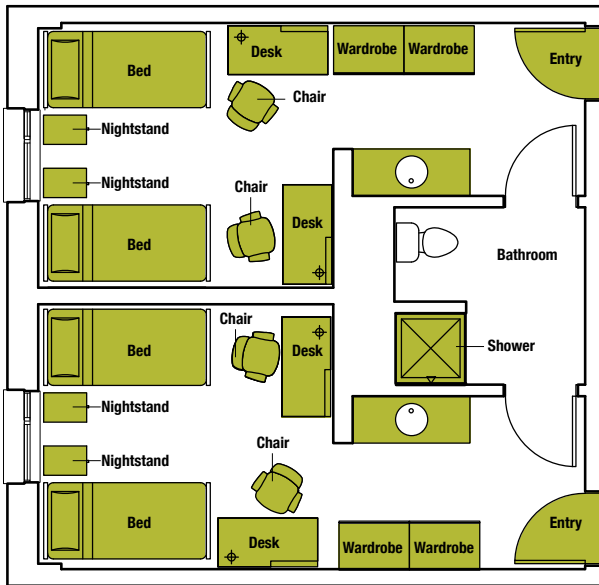

▲ On-Campus: Double suite-style with shared bathroom

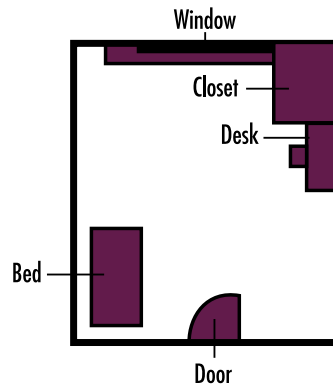

▲ On-Campus: Single room with shared bathroom*

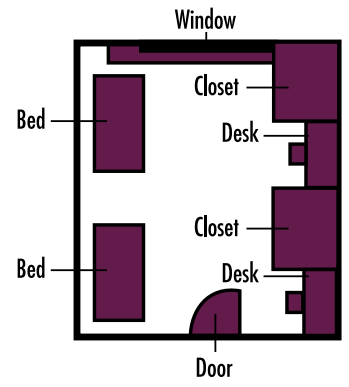

▲ On-Campus: Double standard with shared bathroom



▲ Off-Campus: Apartment-style with private bedroom and bathroom

Housing Options

There is a variety of housing options available to suit the needs of every student.

On-campus Room Types

On-campus housing is available to all international students in 15 different residence halls across campus. These halls offer a wide range of room types. The most popular room types for college students in the US are the Double Standard and Double Suite-Style rooms with shared restroom.

Room types include:

- Double Room with Standard Shared Restroom
- Double Room with Suite-style Shared Restroom
- Double Room with Private Restroom*
- Single Room with Shared Restroom*
- Single Room with Private Restroom*

To watch a video showing all of the different room types, please visit: intohigher.com/osu/housing

Community Themes

On-campus housing offers many themed communities that are available to students by request or application. These include:

- Female-only and male-only communities
- Spirituality suite
- Global Village
- Study-intensive wings
- Substance-free wings

Global Village

The Global Village is an on-campus housing community for undergraduate students who are passionate about cultural exchange and global experiences. For more information and to apply for the Global Village program, please visit: oregonstate.edu/uahds/globalvillage

The Global Village features:

- International-domestic roommate pairs
- Culture-focused hall programming
- Opportunities to connect with OSU faculty outside of the classroom
- Hands-on service learning projects

Homestay

OSU has a network of carefully selected homestay hosts who welcome international students into their homes. Students may have a private or shared room and can enjoy a daily meal with their host families. The number of available families is limited. For more information about OSU Homestay, please visit: oregonstate.edu/uahds/homestay-student-information

Family Housing

Family housing is available for students with families wishing to live on campus. For more information, please visit: oregonstate.edu/uahds/family-housing

Off-campus Graduate Housing

Off-campus graduate housing is available to all students with Graduate Pathway in their study plan. Students are required to sign a housing contract for three terms (9-months). Off-campus graduate housing features:

- Apartment-style living: four private bedrooms with private bathrooms
- Shared living room and full kitchen
- Fully furnished bedrooms and common rooms
- Located within walking distance of the INTO OSU Center

Other Housing Options

For students whose programs do not have an on-campus housing requirement, a variety of off-campus options, such as apartments, houses and rooms to rent can be found throughout the community.

For information about off-campus housing in the Corvallis community, please visit: oregonstate.edu/uahds/off-campus

*Availability of these room types is very limited.

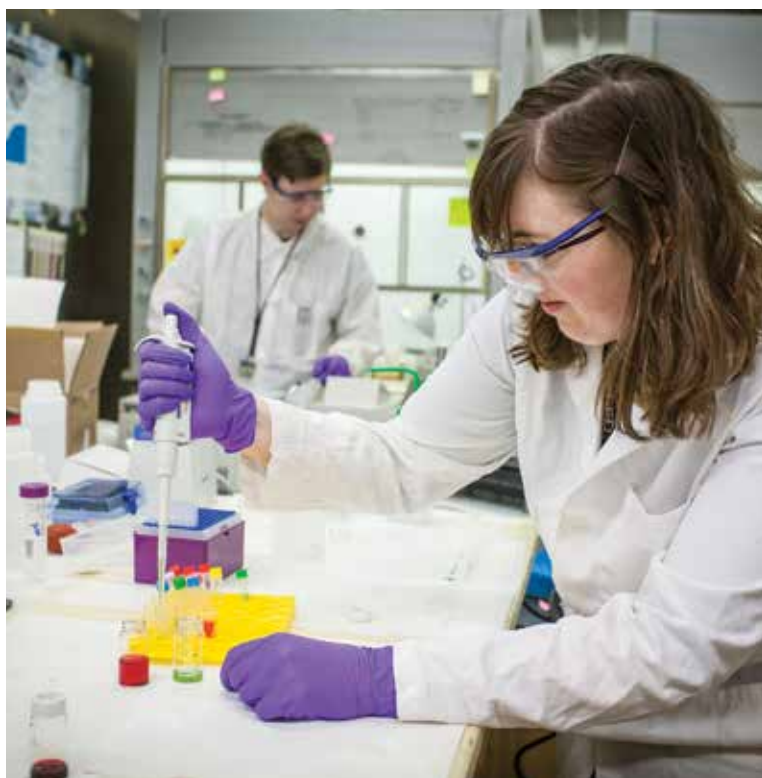

- Intel employs about 800 Oregon State alumni
- 60% of Garmin's software engineers graduated from OSU's College of Engineering
- A recent computer science graduate started an entry-level position at \$92,000 US per year

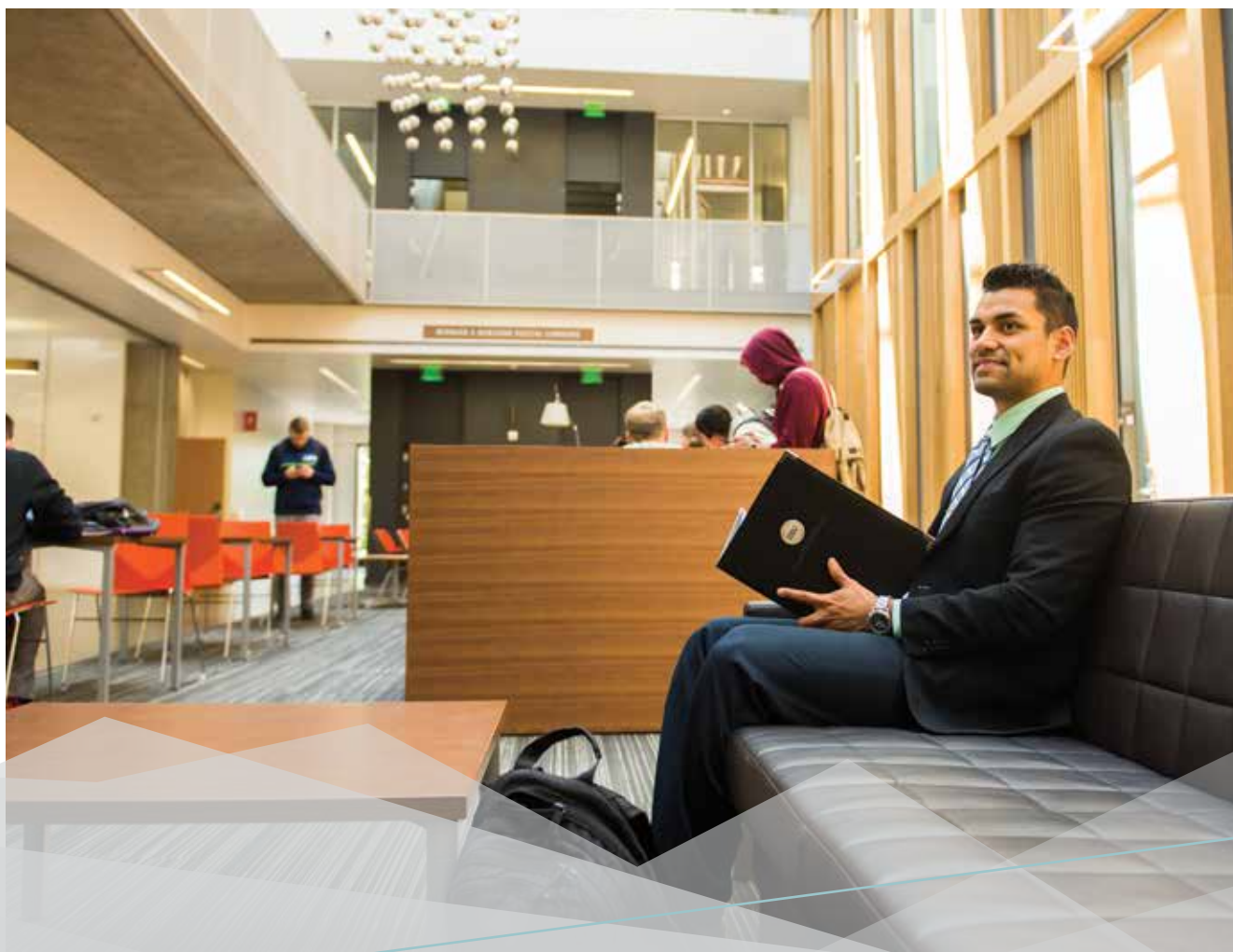

Career Preparation

OSU is a great place to prepare for a successful career. Oregon State University graduates were rated in the top 25% of desirable graduates to hire by *The Wall Street Journal* in 2012.

Engineering: The Multiple Engineering Cooperative Program

The Multiple Engineering Cooperative Program is an innovative internship program which places students in paid engineering and business-oriented internships with some of the world's top companies including Boeing, Intel and Nike. Students have two six-month internships which allow them to develop real-world skills and make the most of their education. For more information about MECOP, please visit: mecopinc.org

Business: Austin Entrepreneurship Program

The Austin Entrepreneurship Program is a unique living-learning environment for undergraduates offering entrepreneurship courses, hands-on experience and the opportunity to explore business ideas. For more information about AEP, please visit: business.oregonstate.edu/aep

Work While Studying

Degree-seeking international students on F-1 visas are eligible to work on campus for up to 20 hours per week while the term is in session and up to 40 hours per week between terms and summer vacations. Students who would like to participate in a paid off-campus academic internship during their degree program may be authorized for Curriculum Practical Training. F-1 international students in language training programs (including Pathway programs) are not eligible for employment or practical training.

Leadership Experience

It is also important to get leadership experience while you are in college. Employers hire students who have been involved in different activities on their campus or in their community. Oregon State University has a variety of clubs and organizations, so find one that is right for you, get involved and make your résumé stronger.

Career Development Center

The Career Development Center can help you develop résumé writing and interview skills and meet potential employers. They also can help eligible degree-seeking students find student employment.

Graduate Assistantships

Graduate students may be offered a teaching or research assistantship on campus. In exchange for their teaching or research service, students receive a monthly salary, tuition remission and an institutional contribution toward the health insurance program available only to graduate assistants. Teaching and research assistantships are offered on a competitive basis and are generally administered by the academic departments.

Working After Graduation

Oregon State University provides career support services from a variety of academic and administrative departments to help prepare you for your next steps after graduation. F-1 students who would like to gain practical work experience in their field of study may be authorized for Optional Practical Training. This authorization is usually to stay and work in the US for one year after graduation.

Internships are available for Engineering and Business undergraduate students



OSU graduates earn a median income 50% higher than other college graduates nationwide (*The Oregonian* 2013)

Alumni and Parents

Beaver Nation has an impressive list of alumni who have made a positive impact on their industry and on the world. They have invented, created and founded world-changing concepts and companies.

Parents and Family

At Oregon State University, we understand the important role that parents and family play in helping choose the right education for their student. Sending your student to study abroad is a major life change and a big investment. We want you to feel assured that you are making the best decision by sending your student to OSU.

Thank you for all that you do to support your student and help them succeed. We believe the more informed you are about OSU, the better resource you can be for your student. Visit our parent pages for more information and frequently asked questions: oregonstate.edu/admissions/main/parents

INTO OSU Alumni

Since the establishment of INTO OSU in 2009, 1,262 international students have successfully completed their Pathway programs and progressed to an OSU degree. More than 330 students have successfully completed their degree and have graduated after studying in an INTO OSU Pathway program.

Famous OSU Alumni

Christian Anderson: won two Pulitzer Prizes and was named editor of the year by the National Press Foundation

Cecil Andrus: secretary of the interior under Jimmy Carter

George Bruns: music director at Walt Disney for more than 25 years

Jennifer Dorn: held four senior leadership posts in the US government

Miles Lowell Edwards: inventor of the Starr artificial heart valve, revolutionizing heart surgery

Douglas Engelbart: inventor of the computer mouse, dimensional editing, multiple-window screens, cross-file indexing, e-mail and shared-screen teleconferencing

Dick Fosbury: invented the 'Fosbury Flop' a technique for going over the bar backward that revolutionized the sport of high jumping

Jen-Hsun Huang: co-founder and CEO of NVIDIA

Carol Menken-Schaudt: winner of the Olympic gold medal in 1984 in basketball

Bernie Newcomb: co-founder of E*Trade, one of the first internet stock trading companies in the US

Hüsnü Özyegin: engineer and famous Turkish philanthropist

Linus Pauling: awarded Nobel Prize in Chemistry and Nobel Peace Prize, only person honored with two unshared Nobel prizes in the world

Donald Pettit: NASA Astronaut

John Young: CEO of HP for over 10 years

Iwandi Yusuf: Governor of the province of Aceh in Indonesia



"The bridge classes at INTO OSU really helped me. The teachers taught me how to speak in class and how to write professionally. It really prepared me for my degree at OSU."

Jianchenyang Zhang, China

Scholarships

OSU Scholarships*

For the most current information on OSU scholarships, please visit: oregonstate.edu/admissions/international/scholarships

Scholarship	Amount	Eligibility	Notes	More Online
International Cultural Service Program Undergraduate and graduate students may apply for this scholarship promoting cultural diversity and increasing cultural awareness and understanding on campus, in the community and across Oregon.	Approximately \$15,000/year	Fully admitted to OSU as an undergraduate or graduate international student Overall GPA of 3.0 or higher Involvement in the ICSP and willing to share information about their country and culture	Renewable with annual renewal application.	oregonstate.edu/international/ICSP
Provost's International Scholarship Entering undergraduate students are automatically considered for this scholarship.	\$9,000/year, up to 4 years	Fully admitted to OSU as an international transfer or freshman undergraduate student Incoming GPA of 3.5 or higher Non-resident tuition status	Renewable with a min GPA of 3.0 No application required for renewal	oregonstate.edu/admissions/international/scholarships-inquiry
International Baccalaureate Scholarship Undergraduate students who have completed the full International Baccalaureate Diploma may be awarded this scholarship.	\$3,000/year, up to 4 years	Fully admitted to OSU as an international transfer or freshman undergraduate student Completion of the full International Baccalaureate Diploma with a score of 30 or higher Non-resident tuition status	Renewable with a min GPA of 3.0 No application required for renewal	oregonstate.edu/admissions/international/scholarships-inquiry

*Scholarship amounts and eligibility requirements are subject to change.

INTO OSU Scholarships*

For the most current information on INTO OSU scholarships, please visit: oregonstate.edu/admissions/international/scholarships

Scholarship	Amount	Eligibility	Notes	More Online
Regional Scholarship Students may apply to their regional INTO representatives for this scholarship.	Variable	Variable	Contact local INTO representative to apply.	oregonstate.edu/admissions/international/scholarships
Honorary Scholarship First-year undergraduate Pathway students may apply for this scholarship sponsored by Ian Sanders and Nancy Heiligman, rewarding leadership, commitment and dedication to higher education.	\$12,000 tuition + \$13,000 housing	Fully admitted to a 3-term standard Pathway program 600-800 word essay describing student's contributions to the community and dreams of the future Eligible to begin class in Fall 2016 Skype interview for all finalists	Send application essay to INTOOSUScholarships@oregonstate.edu Two scholarships available annually	oregonstate.edu/admissions/international/scholarships
Merit-Based Scholarship First-year Pathway students will automatically be considered for this merit-based scholarship.	\$9,000/\$12,500	3.0 overall GPA for graduate 2.9 overall GPA for undergraduate Fully admitted to an INTO OSU 3-term standard Pathway program	No action required. Qualified applicants are automatically considered.	oregonstate.edu/admissions/international/scholarships
Continued Success Scholarship Students who have successfully completed an INTO OSU Pathway program may be awarded this scholarship for their first year of undergraduate or graduate studies at OSU.	\$6,000	3.75 overall GPA during 3-term standard Pathway program Meet all progression requirements after a 3-term Pathway program Fully admitted to an OSU undergraduate or graduate degree-seeking program within the same month the Pathway program ends	No action required. Qualified applicants are automatically awarded.	oregonstate.edu/admissions/international/scholarships

*Scholarship amounts and eligibility requirements are subject to change.



OREGON STATE

Apply via the forms
in this brochure



Apply online at:
intohigher.com/osu/apply



7-10 day
turnaround
for completed
applications

Your Application



Successful applicants receive an offer letter



I-20s are sent within 3 days of confirming enrollment



Study at Oregon State University

OSU and INTO OSU Application Process

1. Determine Course of Study

Decide what academic or English language program you want to apply for.

Read about OSU's degree-seeking and English language programs: oregonstate.edu/admissions/international/programs

2. Check Requirements

Be sure your academic and language scores meet admission requirements for your program of choice.

Detailed admission requirements can be found at: oregonstate.edu/admissions/international/admission-requirements

3. Apply

To apply, visit:

oregonstate.edu/admissions/international/apply

Submit your application and required documents to: intladmit@oregonstate.edu

4. Send Required Documents

Detailed program requirements and instructions can be found at: oregonstate.edu/admissions/international/applying

- Transcripts (copies in native and English language)
- Diplomas (copies in native and English language)
- Language proficiency scores, if applicable
- Test scores, if applicable
- Passport
- Evidence of funding

5. Application Processing

As soon as your application is received, we will notify you by email that it has been received and you may be asked to provide any missing application documents. Your transcripts and other documents must be evaluated, and you will be contacted once an admission decision is made.

6. Offer of Admission

If qualified, we will send you an offer of admission via email.

7. Confirm

Direct OSU Applicants: Return the acceptance form. Once your signed acceptance form has been received we will send you your I-20.

INTO OSU Applicants: Return your signed acceptance form and pay the required deposit. Once your signed acceptance form and deposit have been received we will send you your I-20 to the shipping address provided.

8. Prepare for Arrival

You will receive a Pre-Departure Guide to help prepare you for living and studying in the US.

Application Checklist for Pathway and Direct Undergraduate Degree-seeking Programs

Please read carefully and make sure you have included the following documents in your application package:

1. Application form, completed in full (including signature) and checked for accuracy	<input type="checkbox"/>
2. Copy of passport for student (and spouse/dependents, if applicable)	<input type="checkbox"/>
3. Copy of bank statement and Affidavit of Support or letter of sponsorship	<input type="checkbox"/>
4. Copies of high school or university diploma and transcripts (English and native language)	<input type="checkbox"/>
5. Copies of transcripts of all relevant qualifications translated into English as well as in native language	<input type="checkbox"/>
6. Copies of TOEFL/IELTS/PTEA/Password	<input type="checkbox"/>
7. Copies of visa, I-20 and current DSO information (transfer students)	<input type="checkbox"/>

Application Checklist for English Programs

Please read carefully and make sure you have included the following documents in your application package:

1. Application form, completed in full (including signature) and checked for accuracy	<input type="checkbox"/>
2. Copy of passport for student (and spouse/dependents, if applicable)	<input type="checkbox"/>
3. Copy of bank statement and Affidavit of Support or letter of sponsorship	<input type="checkbox"/>
4. Proof of high school/secondary school graduation (Academic English only)	<input type="checkbox"/>
5. Copies of visa, I-20 and current DSO information (transfer students)	<input type="checkbox"/>

OSU Application Form 1 of 3

Please print legibly and complete all relevant sections of this form (including signature) in black ink. Submit your application and required documents to: intladmit@oregonstate.edu

If you would like to apply to a Graduate Degree program, please complete the online application at: oregonstate.edu/admissions/international/apply

Check one:

INTO OSU Application OSU Undergraduate Degree-seeking Application

If an education counselor is assisting you with your application, fill out the details below. If not, leave this section blank and go to Section 1.

Company/Organization: _____ URN Number: _____

Section 1

A. Student Details

Please enter all names exactly as they appear on your passport.

Last/Family Name _____

First/Given Name _____

Middle Name _____

Gender M F

Date of Birth ____/____/____ mm/dd/yyyy

B. Visa and Immigration Information

Country of Birth _____

Country of Nationality/Citizenship _____

US Residency Status (including dual citizenship)

Non-US Citizen or Non-resident Permanent Resident US Citizen

Are you currently living or studying in the United States? Yes No

If you answered YES, please include a copy of your visa and current I-20.

Will any of your dependents (spouse/children) come to the US with you?

Yes No How many? _____

If yes, please include copies of their passports with your application.

C. Student Permanent Home Country Address

This is the student permanent home country address, it is required for creating the I-20. This address CANNOT be the address of the Education Counselor.

Street _____

City _____ State/Province _____

Country _____ Postal Code _____

Telephone _____

Student Email _____

D. Shipping Address

This is where the I-20 will be mailed.

Education Counselor/Contact Name _____

Street _____

City _____ State/Province _____

Country _____ Postal Code _____

Telephone _____

Contact Email _____

Section 2

English Language Program

Please select your intended program(s) of study and a starting date/term. Do not select programs with conflicting dates.

Academic English (select all that apply)

September 2016 January 2017 March 2017
 June 2017

General English (select all that apply)

September 2016 October 2016 January 2017
 February 2017 March 2017 May 2017
 June 2017 July 2017

General English - College Year Abroad

Please specify total number of weeks 25 35

Select start date:

September 2016 October 2016 January 2017
 February 2017 March 2017 May 2017
 June 2017 July 2017

Please specify number of hours per week

21 hours per week (Standard) 27 hours per week (Intensive)

Study Abroad (select all that apply)

September 2016 January 2017
 March 2017 June 21 2017



OSU Application Form 2 of 3

Section 3

Academic Programs

A. INTO OSU Undergraduate Pathway Programs

1-Term Accelerated 2-Term Accelerated 3-Term Standard/Advanced*

Please select only one box below. Please note that Standard, Advanced and Accelerated options have different entry requirements.

	Fall: Sep 2016	Winter Jan 2017	Spring: Mar 2017
General	<input type="checkbox"/>	<input type="checkbox"/>	<input type="checkbox"/>
Business	<input type="checkbox"/>	<input type="checkbox"/>	<input type="checkbox"/>
Computer Science	<input type="checkbox"/>	<input type="checkbox"/>	<input type="checkbox"/>
Engineering	<input type="checkbox"/>	<input type="checkbox"/>	<input type="checkbox"/>
Exercise and Sport Science	<input type="checkbox"/>	<input type="checkbox"/>	<input type="checkbox"/>
Food Science and Technology	<input type="checkbox"/>	<input type="checkbox"/>	<input type="checkbox"/>
Forestry	<input type="checkbox"/>	<input type="checkbox"/>	<input type="checkbox"/>
General-Liberal Arts Focus	<input type="checkbox"/>	<input type="checkbox"/>	<input type="checkbox"/>
Natural Resources and Renewable Materials	<input type="checkbox"/>	<input type="checkbox"/>	<input type="checkbox"/>
Public Policy	<input type="checkbox"/>	<input type="checkbox"/>	<input type="checkbox"/>
Science	<input type="checkbox"/>	<input type="checkbox"/>	<input type="checkbox"/>
Women and Gender Studies	<input type="checkbox"/>	<input type="checkbox"/>	<input type="checkbox"/>

*Students who qualify will automatically be enrolled in the Advanced Pathway program.

Planned Academic Subject/Major: _____

B. INTO OSU Graduate Pathway Programs

Please select only one box below. Please note that Accelerated and Standard options have different entry requirements.

	Fall: Sep 2016	Winter Jan 2017	Spring: Mar 2017
MBA	<input type="checkbox"/>	<input type="checkbox"/>	<input type="checkbox"/>
Comparative Health Science (MS/PhD)	<input type="checkbox"/>	<input type="checkbox"/>	<input type="checkbox"/>
Civil Engineering	<input type="checkbox"/>	<input type="checkbox"/>	<input type="checkbox"/>
Industrial Engineering	<input type="checkbox"/>	<input type="checkbox"/>	<input type="checkbox"/>
Construction Engineering Management	<input type="checkbox"/>	<input type="checkbox"/>	<input type="checkbox"/>
Mechanical Engineering	<input type="checkbox"/>	<input type="checkbox"/>	<input type="checkbox"/>
Mechanical Engineering with Material Science Emphasis	<input type="checkbox"/>	<input type="checkbox"/>	<input type="checkbox"/>
Environmental Engineering	<input type="checkbox"/>	<input type="checkbox"/>	<input type="checkbox"/>
Chemical Engineering	<input type="checkbox"/>	<input type="checkbox"/>	<input type="checkbox"/>
Electrical and Computer Engineering	<input type="checkbox"/>	<input type="checkbox"/>	<input type="checkbox"/>
Computer Science	<input type="checkbox"/>	<input type="checkbox"/>	<input type="checkbox"/>

C. OSU Undergraduate Direct Degree-seeking Program

Please visit oregonstate.edu/admissions/international for a list of undergraduate majors.

First Year/Freshman Transfer Post-Baccalaureate

Start Date:

Fall: September 2016 Winter: January 2017

Spring: March 2017 Summer: June 2017

Intended Major: _____

Section 4

Student Education History

Please list ALL secondary and post-secondary schools, colleges or universities you have attended or will attend prior to entering the university, including current studies.

You must provide a transcript from each post-secondary school, college or university you have attended, even if you did not complete a term.

A. Secondary Schools/High Schools

(Undergraduate Direct Degree-seeking and Undergraduate Pathway Applicants Only)

Most Recent Secondary School Attended:

School Name: _____

Country: _____

Start: ____/____/____ mm/yyyy End: ____/____/____ mm/yyyy

School Name: _____

Country: _____

Start: ____/____/____ mm/yyyy End: ____/____/____ mm/yyyy

If you have more secondary schools, please submit them in this format on a separate sheet of paper and include with your application.

B. Colleges and Universities

Most Recent Post-secondary School Attended:

College/University Name: _____

Country: _____

Start: ____/____/____ mm/yyyy End: ____/____/____ mm/yyyy

College/University Name: _____

Country: _____

Start: ____/____/____ mm/yyyy End: ____/____/____ mm/yyyy

College/University Name: _____

Country: _____

Start: ____/____/____ mm/yyyy End: ____/____/____ mm/yyyy

If you have more colleges, universities or post-secondary schools, please submit them in this format on a separate sheet of paper and include with your application.

C. Gaps in Study

Will it be more than four (4) months between the time you completed study at your most recent educational institution and the start of your program?

Yes No

If yes, will you have attended a school, college or university in that time?

Yes No

Is that school or university indicated on this application or a separate sheet of paper?

Yes No

OSU Application Form 3 of 3

Section 5

Test Scores

Please indicate all test scores completed. Copies of test results may be used for evaluation, but official results must be received prior to registration.

A. English Language Test Scores

Language scores are valid for two years after the test date and will be considered expired if over two years old at the time of program start date.

TOEFL
 IELTS
 PTEA
 Password
 I do not plan on taking an English language proficiency test.

B. Academic Test Scores (valid for 5 years)

Undergraduate Students	Graduate Students
<input type="checkbox"/> SAT <input type="checkbox"/> ACT	<input type="checkbox"/> GMAT <input type="checkbox"/> GRE
<input type="checkbox"/> I do not plan on taking an academic test.	

Section 6

Housing

Housing selections will only be reserved based on availability and you will be contacted regarding your final reservation. Your housing selection will include a meal plan. See pages 63-65 for details.

Room Selection

For all students with Undergraduate Pathway in their study plan, on-campus housing is required for the first 9 months of study (3 terms). If you do not select one or select Homestay, you will be assigned a default room type. Please rank your top 3 preferences below from 1 to 3, with 1 being your top choice.

Language Program and Undergraduate Pathway Applicants:

Double standard/shared bathroom	<input type="checkbox"/> 1	<input type="checkbox"/> 2	<input type="checkbox"/> 3
Double suite-style/shared bathroom	<input type="checkbox"/> 1	<input type="checkbox"/> 2	<input type="checkbox"/> 3
Double/private bathroom	<input type="checkbox"/> 1	<input type="checkbox"/> 2	<input type="checkbox"/> 3
Single/shared bathroom	<input type="checkbox"/> 1	<input type="checkbox"/> 2	<input type="checkbox"/> 3
Single/private bathroom	<input type="checkbox"/> 1	<input type="checkbox"/> 2	<input type="checkbox"/> 3
Homestay (not available for Undergraduate Pathway applicants)	<input type="checkbox"/> 1	<input type="checkbox"/> 2	<input type="checkbox"/> 3

Graduate Pathway Applicants:

Off-campus graduate housing (3 terms)	<input type="checkbox"/> 1	<input type="checkbox"/> 2	<input type="checkbox"/> 3
Double standard/shared bathroom (3 terms)	<input type="checkbox"/> 1	<input type="checkbox"/> 2	<input type="checkbox"/> 3
Homestay (1 term)	<input type="checkbox"/> 1	<input type="checkbox"/> 2	<input type="checkbox"/> 3

Academic English and Study Abroad with English: Please indicate the number of 3-month terms you would like housing:

1 2 3

General English and College Year Abroad: Please indicate the number of 5-week sessions you would like housing:

1 2 3 4 5 6

As a component of the comprehensive First Year Experience at OSU, full-time, first-year students who enroll at OSU within one year of high school graduation must live on campus for the first 9 months of study (3 terms). Please see the OSU University Housing and Dining Services website for details and information on how to apply: oregonstate.edu/uahds/

Section 7

Declarations Required

Are you eligible to enroll at each of the institutions you have attended in the past seven years? Yes No

I confirm that I have included information on all of my academic studies and will not further study prior to joining this university. Failure to provide this information can result in dismissal from the university.

I certify that all statements made and documents submitted for this application are complete and true to the best of my knowledge. My admission and continuing status at OSU is conditional on such completeness and truthfulness. I also understand that if I am admitted to OSU and do not enroll for the term to which I am admitted AND wish to apply to another term, I must notify the Office of International Admissions in writing to update my file if I am applying in the same or subsequent academic years. If I wish to apply after one academic year from the original application date, I understand that I must submit a new application.

Student Name: _____

Student Signature: _____
 Date ____/____/____ mm/dd/yyyy

Parent/Guardian Name: _____
 (Parent/Guardian signature required for students under age 18)

Parent/Guardian Signature: _____
 Date ____/____/____ mm/dd/yyyy

IMPORTANT PLEASE READ

Authorization for Release of Information

For the purpose of allowing others to assist me with my education, I authorize Oregon State University and INTO Oregon State University, Inc. to release information regarding my application materials as necessary to facilitate the application process for any INTO OSU or OSU academic program.

I authorize INTO Oregon State University, Inc. to release information regarding my student records as necessary to facilitate enrollment and continued progress through any academic program at INTO OSU.

This authorization specifically permits Oregon State University, INTO Oregon State University, Inc., and INTO University Partnerships Ltd. to share my OSU and INTO OSU application materials and INTO OSU student records among them and to provide access to those materials and records to any representative, sponsor or parent listed below. This authorization remains valid during the OSU and INTO OSU application process and throughout my enrollment in an INTO OSU program.

I authorize my application materials for an INTO OSU program to be considered and reviewed by other INTO University Partnerships LTD. joint ventures in the United States in the case that my application is unsuccessful to an INTO OSU program.

Travel and Medical Insurance

The full cost of the International Student Health Plan will be added to the student's account unless evidence of approved alternative health plan has been approved by the OSU Student Health Center: studenthealth.oregonstate.edu/international-students

Terms and Conditions

I state that I have read and understood the INTO OSU brochure and agree to abide by the 2016-17 Terms and Conditions found online: intohigher.com/osu/terms

My Education Counselor (Company/Organization) _____

My Sponsor (Name) _____

My Parent(s) or Other Relative _____

Other (Name) _____

Student's Name (Please Print) _____

Student Signature _____
 Date ____/____/____ mm/dd/yyyy



Oregon State University

Affidavit of Support



Financial Declaration Requirements and Affidavit of Support

If it is determined that you are admissible to Oregon State University, OSU can provide you with an I-20 (F-1) or DS-2019 (J-1) only after you submit satisfactory evidence that you have adequate funds for your proposed program of study. Acceptable financial documents must have been issued (by the financial institution) within 6 months of the date the application was submitted with the Affidavit of Support (below) if necessary. Please refer to the following website for financial amounts required to be shown at time of application for each program: oregonstate.edu/admissions/international/applying/certification-finances. Be sure to keep copies of your financial documents as you will need to present them to the US Consular Officer at your visa interview and to the US Immigration Officers at the Port of Entry.

Parent/Personal sponsor whose name is on financial documents must complete this portion.

Spouses, relatives and other personal sponsors are required to complete the "Affidavit of Support" form when funds held in their name are provided as financial documentation by an international student at time of application. The Affidavit of Support helps confirm the legitimacy of financial documentation presented by the student.

I, _____ hereby certify that I am willing
(Print name of family member/personal sponsor)

and able to provide the amount of \$ _____ in US dollars to meet the expenses incurred
by _____
(Print student's full name)

during the length of the student's study to which their application pertains.

My relationship to the student is that of: _____. I have authorized the release of my supporting financial documents to verify that the promised financial resources are available to me. I affirm that I know and understand the contents of this affidavit signed by me and that the statements are true and correct.

Required:

Signature of family member/personal sponsor: _____ Date: _____

The following documents are not acceptable for proof of funding: stock holdings, life insurance policies, employment letters, credit lines and mortgages. Please note US visa regulations restrict student employment, and therefore, it is important not to rely on employment for income to offset your educational expenses.

Certification of Financial Support

Example Sources of Funding and Required Documentation. All amounts must be in United States currency or show applicable conversion rate.

Source of Funding	Required Documentation
Personal bank statement (checking/savings)	Certified bank letter/bank statement
Parent(s)/Personal sponsor(s)	Affidavit of Support (attached) and certified bank letter/bank statement
Government agency (home country)	Letter of award

Country Scales - Undergraduate Standard Pathway

Country	OSU Undergraduate Standard Pathway
GCSE/IGCSE	5 subjects with 3 grades of C or better and 2 grades of D or better. Subjects must include Math, English, Science, 2 electives.
GCSE/IGCSE A-Levels	GCE/IGCSE Advanced Level - 2 subjects with 1 grade of C and 1 grade of D, and meet the GCSE or GCE 'O' Level requirements.
IB Diploma	IB Diploma w/minimum score of 24; Average grades of 4 or higher (1-7) if by individual courses.
Azerbaijan	Senior High School Graduation Diploma with an average of 3.5 on a 5-point scale
Bahrain	Secondary School Leaving Certificate or General Certificate of Secondary Education. An average of 55% out of 100%.
Bangladesh	Secondary School Certificate & Higher Secondary Certificate result cards issued by Board of Intermediate & Secondary Education, with average of 45% out of 100%.
Brazil	Certificado de Conclusao de Segundo Grau with an average 6.50 out of 10 or 65.5% out of 100%.
Cameroon	GCSE O Level with 3 grades of C and 2 grades of D. Or Baccalaureat de L'Enseignement Secondaire with average of 11 out of 20.
Canada	Each province is different
China P.R.	Senior High School Graduation Diploma or Upper Middle School Graduation Certificate-Transcripts from grades 9-12. An average of 75% out of 100%
Colombia	Completion of Secondary Education - Bachiller. An average of 7.0 on a 10 point scale.
Cyprus	Apolytριο Lykeiou (School Leaving Certificate- Greek) or Lise Diploması (Turkish). Average of 15 out of 20 (Southern Cyprus) or 6 out of 10 (Northern Cyprus).
Ecuador	Secondary School Diploma - Bachillerato. An average of 7.5 on a 10 point scale.
Germany	Zeugnis der Allgemeinen Hochschulreife/Zeugnis der Fachhochschulreife, with average of 3 out of 6 (grade 1 is high) or 7 out of 15 (grade 15 high).
Ghana	Senior Secondary School Certificate Exam with minimum of 5 subjects and average of 4 where 1 is high. Subjects must include English, Math and Science.
Hong Kong	HKDSE with 4 Core subjects (Math, English, Science and Liberal Science) with score of 3 or higher and 1 elective with a 2 or higher.
India	Secondary School Certificate (SSC) and Higher Secondary School Cert (HSC) with an average of 50% out of 100%.
Indonesia	SMA or STTB with grades for Years 9-12 and an average of 6.5 on a 10 point scale OR 65% out of 100%
Iran	Completion of the Diplom-Metevaseth (Certificate of Completion of Secondary Education). An average of '13' on a 20 point scale.
Italy	Diploma di Maturita/Diploma di Perito indicating all exams taken, with an average of 6.5 on a 10 point scale or 40% out of 60%.
Japan	Upper Secondary School Leaving Certificate (grades 9-12) with an average of 2.5 on a 4.0 scale or 3.5 on a 5 point scale.
Jordan	General Secondary Education Certificate (Tawjih) with an average of 65% out of 100%.
Kazakhstan	Senior High School Graduation Diploma - Attestation of Complete Secondary Education An average of '3.5' on a 5 point scale
Kenya	Kenya Certificate of Secondary Education. 8 subjects with an average of 'C+' or better or '7' on a 12 point scale.
Kuwait	High School (grades 9-12) or General Secondary Education Certificate. 75% out of 100%.
Kyrgyzstan	General Certificate of Secondary Education. An average of '3.5' on a 5 point grading scale.
Malaysia	SPM - Require 5 subjects with an average of C+. Subjects must include Math, English, and Science
Morocco	Senior High School Graduation Diploma - Diplome du Baccalaureat, Attestation, General Certificate of Education. An average of 11.5 on a 20 point scale
Myanmar	Senior High School Graduation Diploma - BESE Matriculation. An average grade of 45% out of 100% or 3.5 on a grading scale of 5.0
Netherlands	Senior High School Graduation Diploma/Senior General Education Secondary Certificate with transcripts, and average of 6.5 on a 10 point scale.
Nigeria	West African School Certificate of Education (WAEC) with 5 subjects and average of 4.0 where 1 is high. Subjects must include English, Math and Science.
Oman	General Secondary School Certificate. 73% out of 100%
Pakistan	Secondary School Certificate (SSC) and Higher Secondary School Cert (HSC) with an average of 50% out of 100%.
Qatar	Al-Thanawiya Aama Qatari - General Secondary School Certificate. An average of 70% out of 100%
Russia	Attestat o Srednem (polnom) Obschem Obrazovanii - Certificate of Secondary (Complete) General Education. An average of '3.5' on a 5 point scale.
Saudi Arabia	Examination results for the General Secondary Education Certificate (GSEC), 75% out of 100%
Singapore	Singapore-Cambridge GCE O Level with 5 subjects and an aggregate score of 32.5 or less. Subjects must include English, math and science.
South Africa	Senior High School Graduation Diploma - Senior Certificate with an average of 55% out of 100% or an average of 3.5 on a 6 point scale.
South Korea	High School (grades 9-12). 65% out of 100% OR 2.50 on a 4.0 scale.
Taiwan	Senior High School Diploma. 65% out of 100% OR 2.50 on a 4.0 scale.
Tanzania	EAGCE with 3 Grades of C or better and 2 grades of D and must include English, Math and Science.
Thailand	Certificate of Upper Secondary Education/(Matavom VI). 2.5 GPA on a 4.0 scale or 65% out of 100%
The Gambia	Senior Secondary School Certificate (WAEC) 5 subjects with 3 grades of C and 2 grades of D or an aggregate of 17 or less.
Turkey	Lise Diploması/Secondary Diploma with average of 6.5 on a 10 point scale or 3.5 on a 5 point scale or 63% out of 100%.
Ukraine	Certificate of Complete General Secondary Education or Matriculation Certificate (Atestat) with average of 3.5 on a 5 point scale or 6.5 out of 12.
United Arab Emirates	General Secondary Education Diploma with an average of 75% out of 100% or a 2.50 GPA on a 4.0 grading scale.
United Kingdom	GCSE O Level with 5 subjects and 3 grades of C and 2 grades of D. Subjects must include English, math and science.
United States of America	High School Diploma with a 2.50 GPA on a 4.0 grading scale
Uzbekistan	Senior High School Graduation Diploma - Attestat - Certificate of Secondary Education. An average of '3.5' on a 5 point scale.
Venezuela	Senior High School Graduation Diploma/Bachiller en Ciencias/Humanidades. An average of 12 on a 20 point scale.
Vietnam	Bang Tot Nghiep Pho Thong Trung Hoc (Diploma of completion of Secondary School (Upper). An average of '6.5' on a 10 point scale.
Zimbabwe	General Certificate of Education Ordinary Level, 5 subjects with an average of 4.5 (grade 1 is high). Subjects must include English, Math and Science.

This guide is used for evaluation purposes by the OSU Office of International Admissions and is supplied here for reference only. Meeting the requirements listed here does not necessarily indicate that a student will qualify for admission to Oregon State University or INTO Oregon State University.

When referring to the following guides, be aware that this is not inclusive of all grading requirements. Grading systems and educational structures vary widely around the world and we evaluate each application individually to determine if the applicant meets the standards for success at Oregon State University.

Undergraduate Direct Entry and Accelerated Pathway

Country	OSU Direct Entry and Accelerated Pathway
GCSE/IGCSE	5 subjects with grades of C or better. Subjects must include Math, English, Science, and 2 electives.
GCSE/IGCSE A-Levels	GCE/IGCSE Advanced Level - 2 subjects with grades of C or better, and meet the GCSE or GCE 'O' Level requirements.
IB Diploma	IB Diploma with minimum score of 26. Average grades of 4 or higher (1-7) if by individual courses.
Azerbaijan	Senior High School Graduation Diploma with an average of 4.0 on a 5 point scale
Bahrain	Secondary School Leaving Certificate or General Certificate of Secondary Education. An average of 60% out of 100%.
Bangladesh	Secondary School Certificate & Higher Secondary Certificate result cards issued by Board of Intermediate & Secondary Education, with average of 50% out of 100%.
Brazil	Certificado de Conclusao de Segundo Grau with an average 7.0 out of 10 or 70% out of 100%.
Cameroon	GCSE O Level with 5 grades of C or better. Or Baccalaureat de L'Enseignement Secondaire with average of 12 out of 20.
Canada	Each Province is different
China P.R.	Senior High School Graduation Diploma or Upper Middle School Graduation Certificate-Transcripts from grades 9-12. An average of 80% out of 100%
Colombia	Completion of Secondary Education - Bachiller. An average of '7.5' on a 10-point scale.
Cyprus	Apolitirio Lykeiou (School Leaving Certificate- Greek) or Lise Diplomasi (Turkish). Average of 16 out of 20 (Southern Cyprus) or 7 out of 10 (Northern Cyprus).
Ecuador	Secondary School Diploma - Bachillerato. An average of 8 on a 10-point scale (Buena/Good).
Germany	Zeugnis der Allgemeinen Hochschulreife/Zeugnis der Fachhochschulreife, with average of 2 out of 6 (grade 1 is high) or 10 out of 15 (grade 15 high).
Ghana	Senior Secondary School Certificate Exam with minimum of 5 subjects and average of 3 where 1 is high. Subjects must include English, Math and Science.
Hong Kong	HKDSE with 4 Core subjects (Math, English, Science and Liberal Science) with score of 4 or higher and 1 elective with a 3 or higher.
India	Secondary School Certificate (SSC) and Higher Secondary School Cert (HSC) with an average of 60% out of 100%.
Indonesia	SMA or STTB with Grades for Years 9-12 and an average of 7 on a 10 point scale or 70% out of 100%
Iran	Completion of the Diplom-Metevaseh (Certificate of Completion of Secondary Education); An average of 14 on a 20-point scale.
Italy	Diploma di Maturita/Diploma di Perito indicating all exams taken, with an average of 7 on a 10 point scale or 44% out of 60%.
Japan	Upper Secondary School Leaving Certificate (grades 9-12) with an average of 3.0 on a 4.0 scale or 4.0 on a 5 point scale.
Jordan	General Secondary Education Certificate (Tawjih) with an average of 70% out of 100%.
Kazakhstan	Senior High School Graduation Diploma - Attestation of Complete Secondary Education. An average of 4 (Good) on a scale of 5.0
Kenya	Kenya Certificate of Secondary Education. 8 subjects with an average of 8.0 on a 12-point scale.
Kuwait	General Secondary Education Certificate. 80% out of 100%
Kyrgyzstan	General Certificate of Secondary Education. An average of 4 on a 5-point grading scale.
Malaysia	SPM - Require 5 subjects with an average of B. Subjects must include Math, English and Science
Morocco	Senior High School Graduation Diploma - Diplome du Baccalaureat, Attestation, General Certificate of Education. An average of 12 on a 20-point scale
Myanmar	Senior High School Graduation Diploma BESE Matriculation An Average grade of 50% out of 100% or a 4.0 on a grading scale of 5.0.
Netherlands	Senior High School Graduation Diploma/Senior General Education Secondary Certificate with transcripts, and average of 7.0 on a 10-point scale.
Nigeria	West African School Certificate of Education (WAEC) with 5 subjects and average of 5.0 where 1 is high. Subjects must include English, Math and Science.
Oman	Thanawiya Amma/General Secondary School Certificate; 80% out of 100%
Pakistan	Secondary School Certificate (SSC) and Higher Secondary School Cert (HSC) with an average of 60% out of 100%.
Qatar	Al-Thanawiya Aama Qatari - General Secondary School Certificate; 75% out of 100%.
Russia	Attestat o Srednem (polnom) Obschem Obrazovanii - Certificate of Secondary (Complete) General Education. An average of 4 on a 5-point scale.
Saudi Arabia	Shahadat Al-Marhalat Al-Thanawiyat/General Secondary Education Certificate (GSEC); 80% out of 100%
Singapore	Singapore-Cambridge GCE O Level with 5 subjects and an aggregate score of 30 or less. Subjects must include English, Math and Science.
South Africa	Senior High School Graduation Diploma - Senior Certificate with an average of 60% out of 100% or an average of 4.0 on a 6 point scale.
South Korea	High School (grades 9-12) issued in English and sent directly to OSU by the institution attended. 80% out of 100% (Wu)
Taiwan	Senior High School Diploma. 70% out of 100% or 3.00 GPA on a 4.00 scale
Tanzania	EAGCE in 5 subjects with grades of C or Better and must include English, Math and Science
Thailand	Certificate of Upper Secondary Education/(Matayom VI); 3.00 GPA on a 4.0 scale or 70% out of 100%
The Gambia	Senior Secondary School Certificate (WAEC) 5 subjects with grades of C or better or an aggregate of 15 or less.
Turkey	Lise Diplomasi/Secondary Diploma with average of 7.0 on a 10 point scale or 4.0 on a 5 point scale or 70% out of 100%.
Ukraine	Certificate of Complete General Secondary Education or Matriculation Certificate (Atestat) with average of 4.0 on a 5 point scale or 7.0 out of 12.
United Arab Emirates	General Secondary Education Diploma with an average of 80% out of 100% or a 3.0 GPA on a 4.0 grading scale.
United Kingdom	GCSE O Level with 5 subjects with grades of C or better. Subjects must include English, math and science.
United States of America	High School Diploma with a 3.0 GPA on a 4.0 grading scale
Uzbekistan	Senior High School Graduation Diploma - Attestat - Certificate of Secondary Education; An average of 4 on a 5-point scale (Good).
Venezuela	13.0 on a 20.0 scale; Senior High School Graduation Diploma/Bachiller en Ciencias/Humanidades
Vietnam	Bang Tot Nghiep Pho Thong Trung Hoc (Diploma of completion of Secondary School (Upper) An average 7.0 on 10.0 scale; or 12.0 on 20.0 scale
Zimbabwe	General Certificate of Education Ordinary Level, 5 subjects with an average of 4.0 (grade 1 is high). Subjects must include English, Math and Science.

Please also be aware that requirements by country are updated and adjusted appropriately throughout an academic year and might not be current in this brochure. For a more recent list of country evaluation scales and graduate-level scales, please visit our website at: oregonstate.edu/admissions/international/admission-requirements-country

English Waiver Guidelines

English Waiver Exemptions	OSU Undergraduate Pathway Program - Standard	OSU Undergraduate Pathway Program - Accelerated	OSU Undergraduate Direct Entry
IELTS	5.5	1-term: 6.0 (5.5 subscores) 2-term: 6.0	6.5
TOEFL	60	1-term: 75* (16 subscores) 2-term: 70	80 (16 subscores)
Password	6	No	No
PTEA (Pearson)	44	No	No
IB	English A Language and Literature HL: 4	English A Language and Literature HL: 5	English A Language and Literature HL: 5
IGCSE/GCSE	English First Language with C or better. ESL C or higher. Not predicted scores.	English First Language with C or better. ESL C or higher. Not predicted scores.	English First Language with C or better. ESL C or higher. Not predicted scores.
A Levels (A/AS)	English First Language with C or better. Not predicted scores.	English First Language with C or better. Not predicted scores.	English First Language with C or better. Not predicted scores.
US High School	3+ years of high school in English, mainstream English classes, with grades of B or better in non-ESL classes. And/or a grade of C or better in an AP English language/ composition.	3+ years of high school in English, mainstream English classes, with grades of B or better in non-ESL classes. And/or a grade of C or better in an AP English language/ composition.	3+ years of high school in English, mainstream English classes, with grades of B or better in non-ESL classes. And/or a grade of C or better in an AP English language/ composition.
English-Speaking Canadian or American-International High School	English Speaking High School in other English-speaking countries (see country list). Same as above (equivalent) -must be accredited/ recognized by country.	English Speaking High School in other English-speaking countries (see country list). Same as above (equivalent) -must be accredited/ recognized by country.	English Speaking High School in other English-speaking countries (see country list). Same as above (equivalent) -must be accredited/ recognized by country.
SAT	450 Verbal	500 Verbal	500 Verbal
ACT	19 English/Reading	21 English/Reading	21 English/Reading
HKDSE	English Level 3 or better	English Level 3 or better	English Level 3 or better
Malaysia SPM	English 119 with C or better	English 119 with C or better	English 119 with C or better
Australia	Yes	Yes	Yes
Canada, except Quebec (French)	Yes	Yes	Yes
Commonwealth Caribbean (Anglophone), including Antigua, Bahamas, Barbados, Belize, Bermuda, Cayman Islands, Jamaica, Trinidad & Tobago	Yes	Yes	Yes
Irish Republic	Yes	Yes	Yes
New Zealand	Yes	Yes	Yes
United Kingdom (England, Scotland, Ireland, Wales)	Yes	Yes	Yes

*Select programs

**For citizens of African countries whose official language is English, waivers will be considered on a case-by-case basis if the medium of instruction is English.

Dates, Tuition and Fees

Oregon State University

Rates are an estimate and subject to change. All prices in US dollars.

By Academic Term There are 4 terms per academic year (fall, winter, spring, summer), each about 12 weeks/3 months.

Prices are estimated for 15 credits per quarter.

Oregon State University Tuition and Fees			
	1 Term	2 Terms	3 Terms
Undergraduate Direct Entry*	\$9,781	\$19,562	\$29,343
Graduate Direct Entry*			
Business MBA	\$11,339	\$22,678	\$34,017
Engineering	\$8,331	\$16,662	\$24,993
Pharm D	\$9,926	\$19,852	\$29,778
Professional Science	\$7,658	\$15,316	\$22,974
Base Graduate Rates	\$7,658	\$15,316	\$22,974

*Based on average full-time student status in the 2014-15 academic year. Tuition and Fees are subject to change.

Oregon State University Accommodation			
Residence Hall Accommodations*	1 Term	2 Terms	3 Terms
Triple	\$2,932	\$5,864	\$8,796
Double, suite-style room with shared bathroom	\$4,080	\$8,160	\$12,240
Double suite-style room with private bathroom	\$4,539	\$9,078	\$13,617
Single room with private bathroom	\$5,011	\$10,022	\$15,033

*Based on International Living-Learning Center rates, including the standard Dining Plan.

Start Dates for Undergraduate OSU Degree Programs

Term	Start Dates	Recommended Application Date	Cost to Apply*
Fall 2016	September 13, 2016	August 24, 2016	\$60
Winter 2017	January 5, 2017	December 9, 2016	\$60
Spring 2017	March 30, 2017	March 6, 2017	\$60
Summer 2017	June 23, 2017	May 29, 2017	\$60

*Students applying through INTO affiliated agencies and educational counselors are not required to pay the application fee.

Start Dates for Graduate OSU Degree Programs

Term	Start Dates	Recommended Application Date*	Cost to Apply
Fall 2016	September 6, 2016	April 1, 2016	\$85
Winter 2017	January 5, 2017	July 1, 2016	\$85
Spring 2017	March 30, 2017	October 1, 2016	\$85
Summer 2017	June 23, 2017	January 1, 2017	\$85

*Application deadlines may vary. Check specific program requirements at gradschool.oregonstate.edu

Considering taking summer term classes at OSU? Tuition is less expensive during summer. See summer.oregonstate.edu for details.

Estimated Costs and Deposits

OSU and INTO OSU Programs

Rates are an estimate and subject to change. All prices in US dollars.

Please visit intohigher.com/osu/costs for more information.

Costs of Attendance for Typical Programs 2016-17

Cost Description	Tuition and Fees	Living Expenses	Books and Supplies	Insurance	Total Estimated Cost of Attendance
Undergraduate Direct Admission (3 Terms)	\$29,343	\$16,000	\$2,500	\$1,950	\$49,793
Undergraduate Pathway (Standard - 3 Terms)	\$29,910	\$15,000	\$2,800	\$1,650	\$49,360
Graduate Direct MBA (3 Terms)	\$34,017	\$16,000	\$2,500	\$1,950	\$54,467
Graduate Pathway MBA (Standard - 3 Terms)	\$30,000	\$15,000	\$2,800	\$1,650	\$49,450
Graduate Direct Engineering (3 Terms)	\$24,993	\$16,000	\$2,500	\$1,950	\$45,443
Graduate Pathway (Standard - 3 Terms)	\$29,910	\$15,000	\$2,800	\$1,650	\$49,360
Academic English (1 Term)	\$5,750	\$5,000	\$600	\$550	\$11,900
General English (1 Session/5 Weeks)	\$2,475	\$3,000	\$275	\$330	\$6,080

*Prices are estimates only for living expenses, books and insurance

Deposits

Cost Description	Tuition and Fees	Housing
General English (including CYA)	\$1,000	\$1,000
Academic English (including SAWE)	\$2,000	\$2,000
Pathway Programs	\$2,000	\$2,000
Academic English + Pathway Program	\$2,000	\$2,000

Dates, Tuition and Fees

INTO Oregon State University

Rates are an estimate and subject to change. All prices in US dollars.

By Academic Term An academic term is about 12 weeks/3 months long. There are 4 terms per academic year (fall, winter, spring, summer).

Tuition for Academic Programs			
Program	1 Term Acc	2 Term Acc	3 Term Standard/Advanced
Undergraduate Pathway Program *	\$11,465	\$22,930	\$29,910
Study Abroad with English: Part 2	\$9,970	\$19,940	\$29,910
Visiting International Student Program	\$9,970	\$19,940	\$29,910
Graduate Pathway Program - MBA *	NA	\$25,300	\$33,000
Graduate Pathway Program - Other *	\$11,465	NA	\$29,910

*1-2 Term prices for UGPW and GPW are for Accelerated Courses.

Start Dates for Academic Programs

Standard Pathway programs (in blue) are 3 terms. Accelerated Pathway programs are either 1 term (in gray) or 2 terms (in orange). Pathway programs can be started in the terms indicated below.

1-term Accelerated Pathway
 2-term Accelerated Pathway
 3-term Standard Pathway

Program	Fall 2016 Sep 13, 2016- Dec 9, 2016	Winter 2017 Jan 3, 2017- Mar 24, 2017	Spring 2017 Mar 27, 2017 - Jun 16, 2017
Undergraduate Pathway Programs			
General	<input type="radio"/>	<input type="radio"/>	<input type="radio"/>
Business	<input type="radio"/>	<input type="radio"/>	<input type="radio"/>
Computer Science	<input type="radio"/>		
Engineering	<input type="radio"/>	<input type="radio"/>	
Exercise and Sport Science	<input type="radio"/>	<input type="radio"/>	<input type="radio"/>
Food Science and Technology	<input type="radio"/>	<input type="radio"/>	<input type="radio"/>
Forestry	<input type="radio"/>	<input type="radio"/>	
General - Liberal Arts Focus	<input type="radio"/>	<input type="radio"/>	<input type="radio"/>
Natural Resources and Renewable Materials	<input type="radio"/>	<input type="radio"/>	<input type="radio"/>
Public Policy	<input type="radio"/>	<input type="radio"/>	<input type="radio"/>
Science	<input type="radio"/>	<input type="radio"/>	<input type="radio"/>
Women and Gender Studies	<input type="radio"/>	<input type="radio"/>	<input type="radio"/>
Graduate Pathway Programs			
Business (MBA)	<input type="radio"/>	<input type="radio"/>	<input type="radio"/>
Comparative Health Sciences (MS/PhD)	<input type="radio"/>		
Engineering (MEng) - ECE/CS	<input type="radio"/>	<input type="radio"/>	<input type="radio"/>
All other Engineering (MEng)	<input type="radio"/>		<input type="radio"/>

Program	Fall 2016 Sep 13, 2016- Dec 9, 2016	Winter 2017 Jan 3, 2017- Mar 24, 2017	Spring 2017 Mar 28, 2017- Jun 16, 2017	Summer 2017 Jun 21, 2017- Aug 18, 2017
Study Abroad with INTO OSU				
Study Abroad with English: Part 2	<input checked="" type="checkbox"/>	<input checked="" type="checkbox"/>	<input checked="" type="checkbox"/>	<input checked="" type="checkbox"/>
Visiting Int'l Student Program	<input checked="" type="checkbox"/>	<input checked="" type="checkbox"/>	<input checked="" type="checkbox"/>	<input checked="" type="checkbox"/>

Variable program length

By 5-Week Session A session is 5-weeks long. There are 8 sessions per academic year.

Tuition for General English and College Year Abroad*						
Program	5 Weeks	10 Weeks	15 Weeks	20 Weeks	25 Weeks College Year Abroad	35 Weeks College Year Abroad
21 hours per week (Standard)	\$2,475	\$4,950	\$6,975	\$9,300	\$11,000	\$15,400
27 hours per week (Intensive)	\$2,950	\$5,900	\$8,400	\$11,200	\$13,375	\$18,725

*The price for all GE programs longer than 25 weeks is \$440/week for 21 hours and \$535/week for 27 hours.

Start Dates for General English and College Year Abroad

College Year Abroad can start at any General English starting date.

Program	Start Dates	End Dates
General English or College Year Abroad	September 19, 2016	October 28, 2016
	October 31, 2016	December 7, 2016
	January 5, 2017	February 10, 2017
	February 13, 2017	March 22, 2017
	March 30, 2017	May 5, 2017
	May 8, 2017	June 14, 2017
	June 22, 2017	July 28, 2017
	July 31, 2017	September 6, 2017

Tuition for English Language Programs			
Program	1 Term	2 Terms	3 Terms
Academic English	\$5,750	\$11,500	\$17,250
Study Abroad with English: Part 1 (AE)	\$5,750	\$11,500	\$17,250

Start Dates for English Language Programs

Program	Fall 2016 Sep 13, 2016- Dec 7, 2016	Winter 2017 Jan 3, 2017- Mar 22, 2017	Spring 2017 Mar 28, 2017- Jun 14, 2017	Summer 2017 Jun 21, 2017- Sep 6, 2017
Academic English	<input checked="" type="checkbox"/>	<input checked="" type="checkbox"/>	<input checked="" type="checkbox"/>	<input checked="" type="checkbox"/>
Study Abroad with English: Part 1 (AE)	<input checked="" type="checkbox"/>	<input checked="" type="checkbox"/>	<input checked="" type="checkbox"/>	<input checked="" type="checkbox"/>

Variable program length

Housing and Dining Prices for Academic and English Language Programs

Housing and dining rates are subject to change. INTO OSU attempts to fulfill room-type requests, however cannot guarantee a specific room type.

	1 Term	2 Terms	3 Terms
On Campus			
Double standard/shared bathroom*	\$3,984	\$7,968	\$11,952
Double suite-style/shared bathroom*	\$4,632	\$9,264	\$13,896
Double/private bathroom*	\$5,460	\$10,920	\$16,380
Single/shared bathroom*	\$5,856	\$11,712	\$17,568
Single/private bathroom*	\$6,600	\$13,200	\$19,800
Off Campus			
Graduate student housing**	\$4,632	\$9,264	\$13,896
Homestay**	\$3,960	\$7,920	\$11,880

*Includes \$770 in dining credit per academic term, a linen package and housing between terms.

**Includes \$385 in dining credit per academic term.

Miscellaneous Fees and Expenses 2016-17

Item	One time	Per Academic Term	Per 5-Week Session
International Express Mail	\$100	NA	NA
Domestic Express Mail	Free of charge	NA	NA
Insurance (estimated)	NA	\$575	\$350
Other Medical Costs (estimated)	NA	\$500	\$100
Books (estimated)	NA	\$600	\$275

Housing and Dining Prices for General English and College Year Abroad

Housing and dining rates are subject to change. INTO OSU attempts to fulfill room-type requests, however cannot guarantee a specific room type.

	5 Weeks	10 Weeks	15 Weeks	20 Weeks	25 Weeks College Year Abroad	35 Weeks College Year Abroad
On Campus						
Double standard/shared bathroom*	\$2,190	\$4,380	\$6,570	\$8,760	\$10,950	\$15,330
Double suite-style/shared bathroom*	\$2,545	\$5,090	\$7,635	\$10,180	\$12,725	\$17,815
Double/private bathroom*	\$3,000	\$6,000	\$9,000	\$12,000	\$15,000	\$21,000
Single/shared bathroom*	\$3,215	\$6,430	\$9,645	\$12,860	\$16,075	\$22,505
Single/private bathroom*	\$3,630	\$7,260	\$10,890	\$14,520	\$18,150	\$25,410
Off Campus						
Homestay**	\$1,980	\$3,960	\$5,940	\$7,920	\$9,900	\$13,860

*Includes \$385 in dining credit per 5-week session, a linen package and housing between sessions.

**Includes \$190 in dining credit per 5-week session.

It pays to be a Beaver

The median income of Oregon State alumni is 50% higher than the median income of college graduates nationwide.



Want to Find Out More?

If you would like to find out more about any of our programs or services, please visit our website. You can also contact us via email or phone, or visit one of our education counselors in your home country.

Inquiries and Applications

INTO Oregon State University

Oregon State University
1701 SW Western Boulevard
Corvallis, OR 97333
USA

T: +1 541 737 2464

F: +1 541 737 4220

E: intladmit@oregonstate.edu

W: intohigher.com/osu



[intohigher.com/
osu](http://intohigher.com/osu)



[facebook.com/
INTO.OregonState](https://facebook.com/INTO.OregonState)



[twitter.com/
INTO_OSU](https://twitter.com/INTO_OSU)



[instagram.com/
INTOoregonstate](https://instagram.com/INTOoregonstate)



[myin.to/
OSU_YouTube](https://myin.to/OSU_YouTube)



Download the mobile app at:
intohigher.com/osu/app

© 2015 INTO USA, LLC. All rights reserved. INTO and the INTO roundel are registered trademarks of INTO University Partnerships Ltd.

MITO ORECON STATE UNIVERSITY

2016-17